

While every attempt has been made to ensure the accuracy and completeness of the information in this document some typographical or technical errors may exist. Blu Performance cannot accept responsibility for customers' losses resulting from the use of this document. Please also note that this drawing / design is subject to change without prior notice in accordance with our policy of continual product development. This drawing / design contains proprietary information that is protected by copyright and is property of Blu Performance. Blu Performance is at the leading edge in joinery hardware, customer care and quality are at the core of everything we do, you can be confident that a call to Blu will be the only call you need for all your joinery hardware needs.

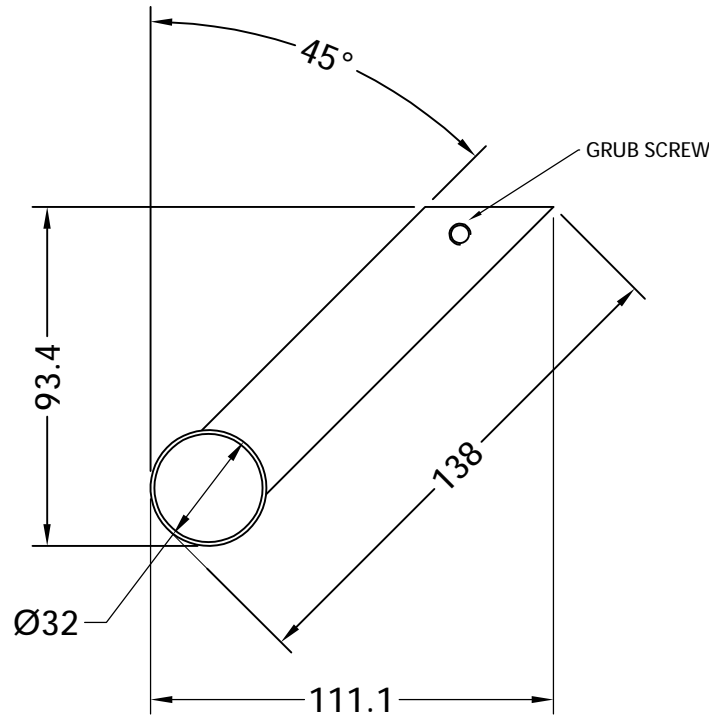

Section A-A

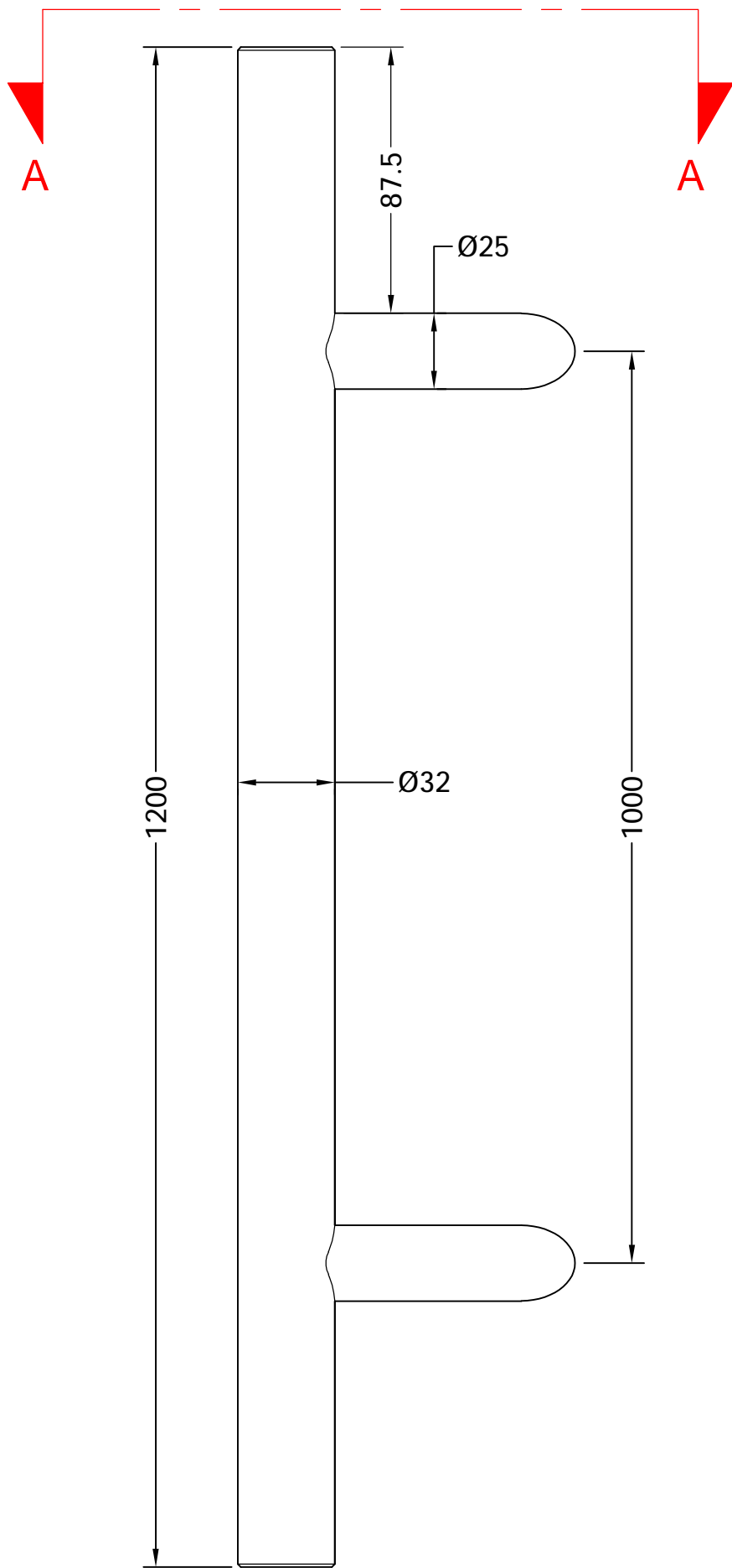
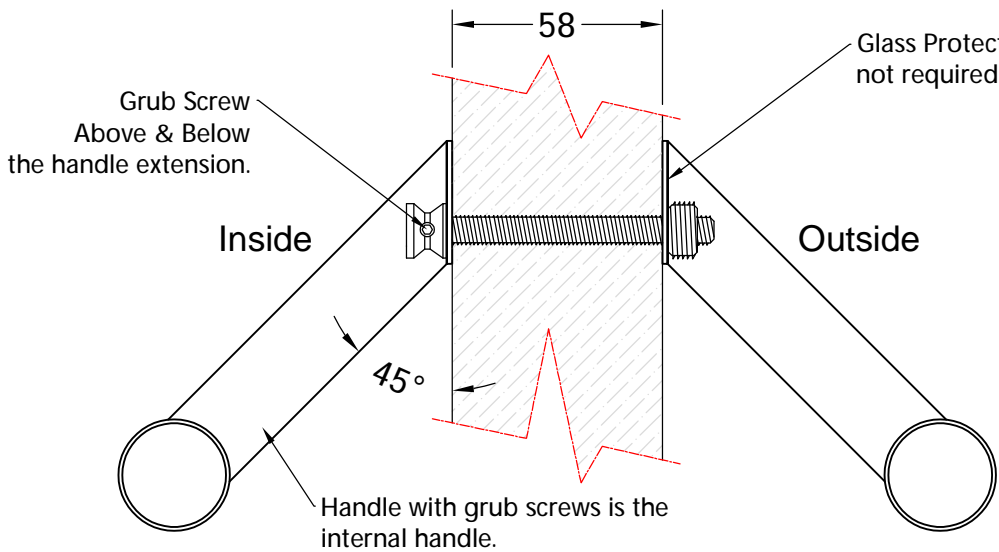

Assembled View (Back to Back)

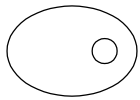

GLASS PROTECTOR PADS
NOT REQUIRED ON TIMBER

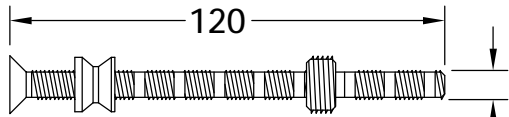

To suit up to 90mm thick doors.

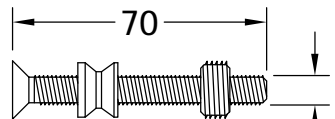

To suit up to 44mm thick doors.

FIXING BOLTS



1 x ALLEN KEY FOR GRUB SCREW

WHATS INCLUDED IN THE BOX	
QTY	DESCRIPTION
1	INTERNAL OFFSET T BAR PULL HANDLE
1	EXTERNAL OFFSET T BAR PULL HANDLE
4	GLASS PROTECTOR PADS
2	120mm CROPPABLE FIXING BOLTS
2	70mm FIXING BOLTS
1	3mm GRUB SCREW ALLEN KEY
2	THREADED FIXING SLEEVE (EXTERNAL)
2	V-GROOVED FIXING SLEEVE (INTERNAL)



Global House
Bojea Industrial Estate
Trethowel, St Austell
Cornwall, PL25 5RJ
t | 01726 871025 f | 01726 871731
e | sales@blu-performance.com
w | www.blu-performance.com

Customer Reference:

blu Performance

Drawing Title:
**1200mm Offset T-Bar Pull Handle
Back to Back Fixing**

Product Range / Project Reference
HAB6-1200-BB-SSS

Other Information: Suits up to door thickness of 90mm.

Date Drawn: 08/07/2016

Drawn By: Phil Walklett

Drawing Number: BP-HAB6-1200-BB-SSS.dwg Revision: A

THIRD ANGLE PROJECTION

This drawing and specification are the property of Coastal Group, they are issued in strict confidence and shall not be reproduced, copied or used without written permission.

Scale: NONE Sheet: 1 of 1