

What we provide

1 - The Official Document

To apply for a Compliance Application Form please contact us on:

01726 871025

or email:

PartQ@coastal-group.com



2 - Glass stickers for completed doors

Available on request with valid certificate



3 - Validation logo

To host on your website and marketing material.



www.coastal-group.com/PartQ · PartQ@coastal-group.com

Coastal Group, Global House, Bojea Industrial Estate, Trethowel, St Austell, Cornwall, PL25 5RJ
T 01726 871025 | F 01726 871731 | Email sales@coastal-group.com | Visit www.coastal-group.com

CGM
COMPLIANCE GUIDE
MANUAL



Helping
Customers
meet Part Q

PART COMPLIANCE Guide Manual

Product Type:

Double Door Open Out.

TEST NUMBER: 16155

7 Parts of PAS24
required to meet part Q

1. Manual Check Test
2. Manipulation Test
3. Mechanical Loading Test
4. Manual Cutting Test
5. Soft Body Impact Test
6. Hard Body Impact Test
7. Security Hardware & Cylinder Test



Details of the PAS24 test can be seen at www.coastal-group.com/PartQ

Coastal have invested in an official PAS24 test. The test certificate can be cascaded down if the door design and component specification is as per this compliance guide.

coastal-group.com/PartQ

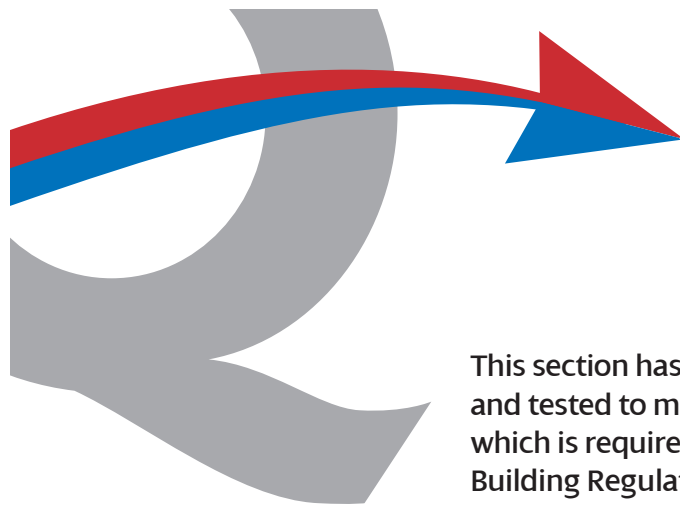

This section has been designed and tested to meet PAS24:2012 which is required for Part Q of Building Regulations

(October 2015)

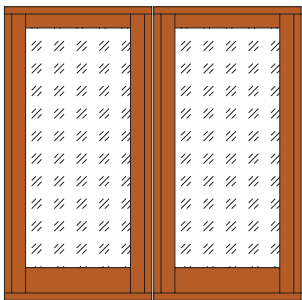

Door type covered in this scope

- Internal and external glazing can be used (both tested on 15857 and 16155)
- Various moulding details can be used.
- 15mm or 18mm frame and glazing rebates can be used (both tested on 15857 and 16155)
- Sections available in pdf or dwg.
- Timber must be denser than 432 KG M³.
- Max outer frame size 2118mm wide x 2620mm high.
- CF16 tape has to be used on sash rebate and glazing beads. Beads also need to be pinned.
- HT4 3D Fully Adjustable Hinges can be used if required - Cross Cascade from test 18538

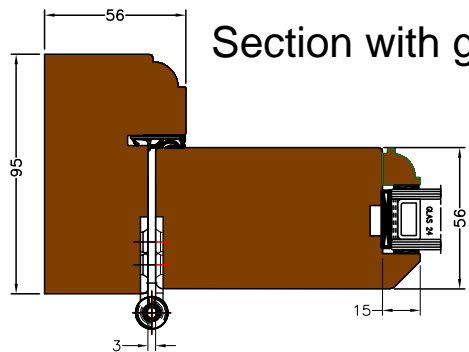

Section with glass

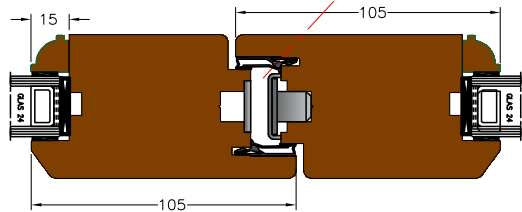

Outside

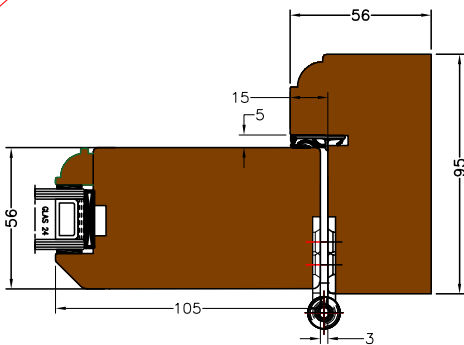

SECTION TESTED

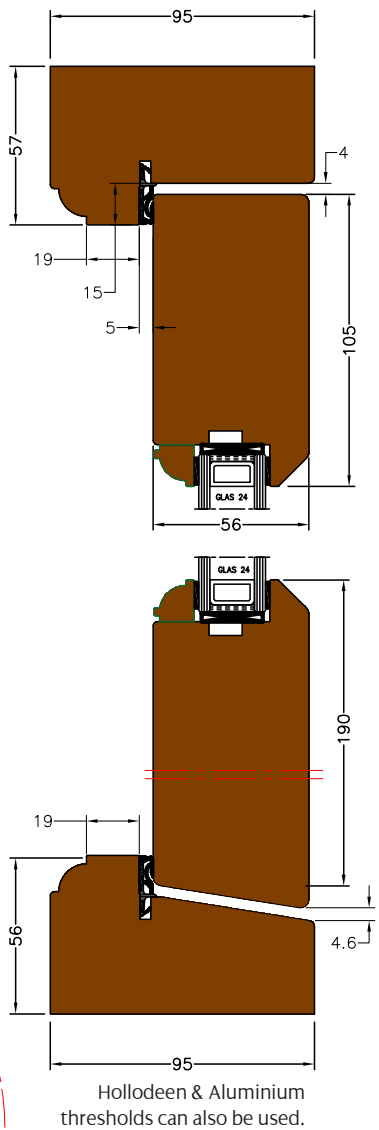

Hollodeen & Aluminium thresholds can also be used.

All measurements shown are minimum. These dimensions cannot decrease but can increase.

Off the shelf tooling block available - please call Whitehill Tooling.

www.coastal-group.com/PartQ · PartQ@coastal-group.com

What Components do I need to use?

Master Lock, Slave Lock, Shoobolt and Keep Kits

ML30-A-KIT-LH	Solo Double Door Kit for Leaf height 1853-1996mm
ML30-A-KIT-RH	Solo Double Door Kit for Leaf height 1853-1996mm
ML30-B-KIT-LH	Solo Double Door Kit for Leaf height 1997-2139mm
ML30-B-KIT-RH	Solo Double Door Kit for Leaf height 1997-2139mm
ML30-C-KIT-LH	Solo Double Door Kit for Leaf height 2140-2281mm
ML30-C-KIT-RH	Solo Double Door Kit for Leaf height 2140-2281mm
ML30-D-KIT-LH	Solo Double Door Kit for Leaf height 2282-2425mm
ML30-D-KIT-RH	Solo Double Door Kit for Leaf height 2282-2425mm
ML30-E-KIT-LH	Solo Double Door Kit for Leaf height 2426-2567mm
ML30-E-KIT-RH	Solo Double Door Kit for Leaf height 2426-2567mm
ML30-F-KIT-LH	Solo Double Door Kit for Leaf height 2496-2639mm
ML30-F-KIT-RH	Solo Double Door Kit for Leaf height 2496-2639mm
ML30-G-KIT-LH	Solo Double Door Kit for Leaf height 2639-2781mm
ML30-G-KIT-RH	Solo Double Door Kit for Leaf height 2639-2781mm
ML30-H-KIT-LH	Solo Double Door Kit for Leaf height 2782-2924mm
ML30-H-KIT-RH	Solo Double Door Kit for Leaf height 2782-2924mm
ML30-I-KIT-LH	Solo Double Door Kit for Leaf height 2925-3066mm
ML30-I-KIT-RH	Solo Double Door Kit for Leaf height 2925-3066mm

EURO CYLINDERS

KPD	KABA 3 Star TS007 Double Cylinder	Any size
KPT	KABA 3 Star TS007 Cylinder & Turn	Any size

Any door handle can be used - All security is covered within the KPD/KPT euro cylinder tested

BUTT HINGES

HQ4-316	102x76x3mm Phosphor Bronze - Square End - Washered Hinge 316 Grade Stainless Steel
HQ4R-316	102x76x3mm Phosphor Bronze - Radiused End - Washered Hinge 316 Grade Stainless Steel
HT4	102x91x2.5mm 80kg 3D Fully Adjustable Hinge - "CROSS CASCADE from test 18538"

3 hinges required for doors up to 2210mm. 4 hinges required for doors up to 2620mm.

SEALS

SPV124-15	Tempo Frame Weatherseal - 2.8x4.2 x8mm Groove for 15mm Rebate - Black
SPV124-18	Tempo Frame Weatherseal - 2.8x4.2 x8mm Groove for 18mm Rebate - Black
CF1612	CoFirm 1.6x12mm Glazing Tape (Black or White) Larger tapes can be used

FIXINGS

RHF440-ZY	4x40mm Red Horse Screws - For Lock & Keep fixings
RHF540-ZY	5x40mm Red Horse Screws - For Butt Hinges
RHF590-ZY	5x90mm Red Horse Screws - For Frame fixing assembly

Use RHF4530 if using Stainless Steel

Other information

Glass - 4/16/4 - Toughened Double Glazed with at least one pane of laminated glass meeting the requirements of BS EN 356:2000, Class P1A, and be glazed in accordance with BS 6262.
Timber - Accoya (510 KG M³)

