

REVISIONS			
Revision	Description	Drawn	Date
A	Release	PW	28/3/18

# Universal Handing

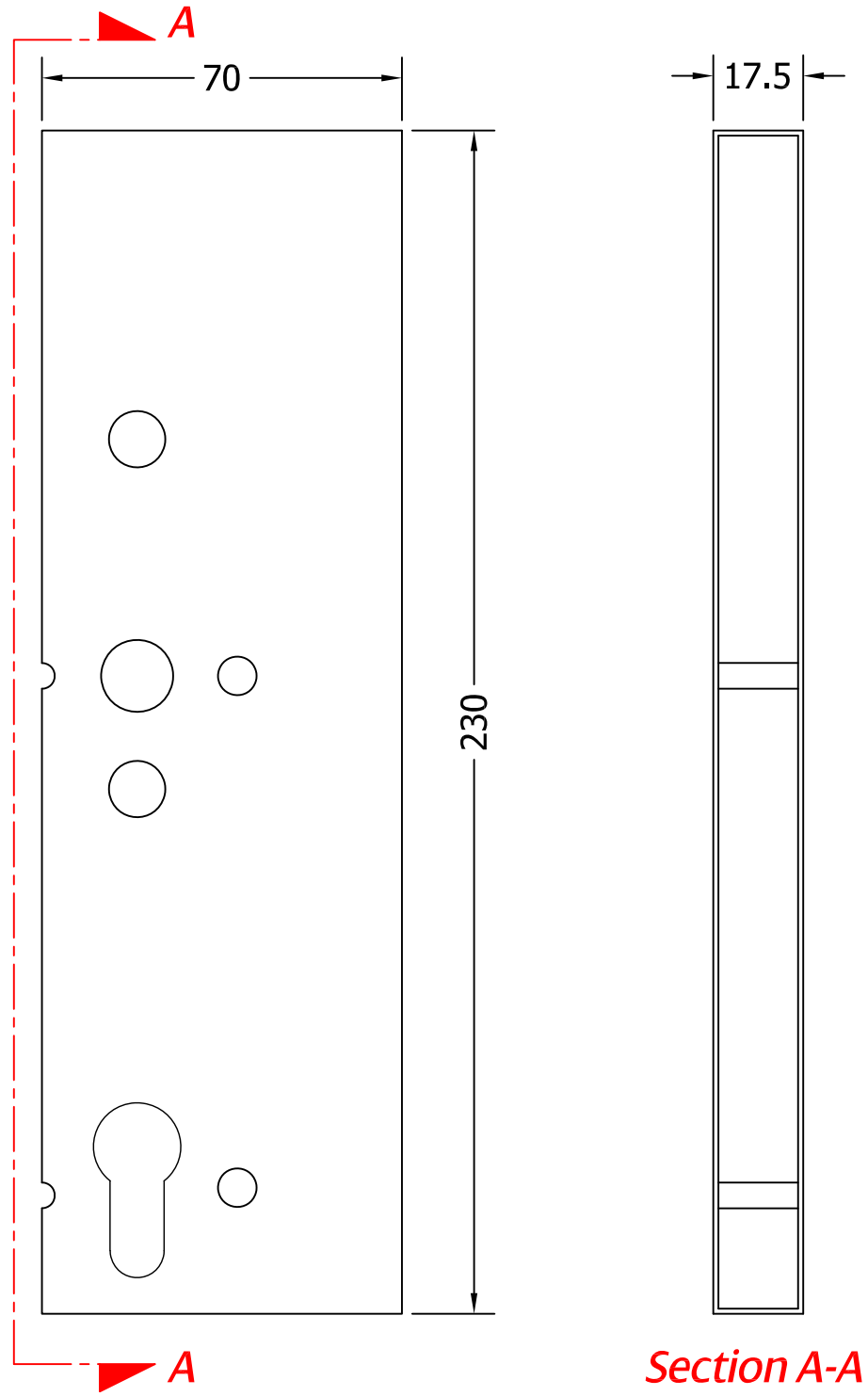

Centre Gearbox Cover

Section A-A

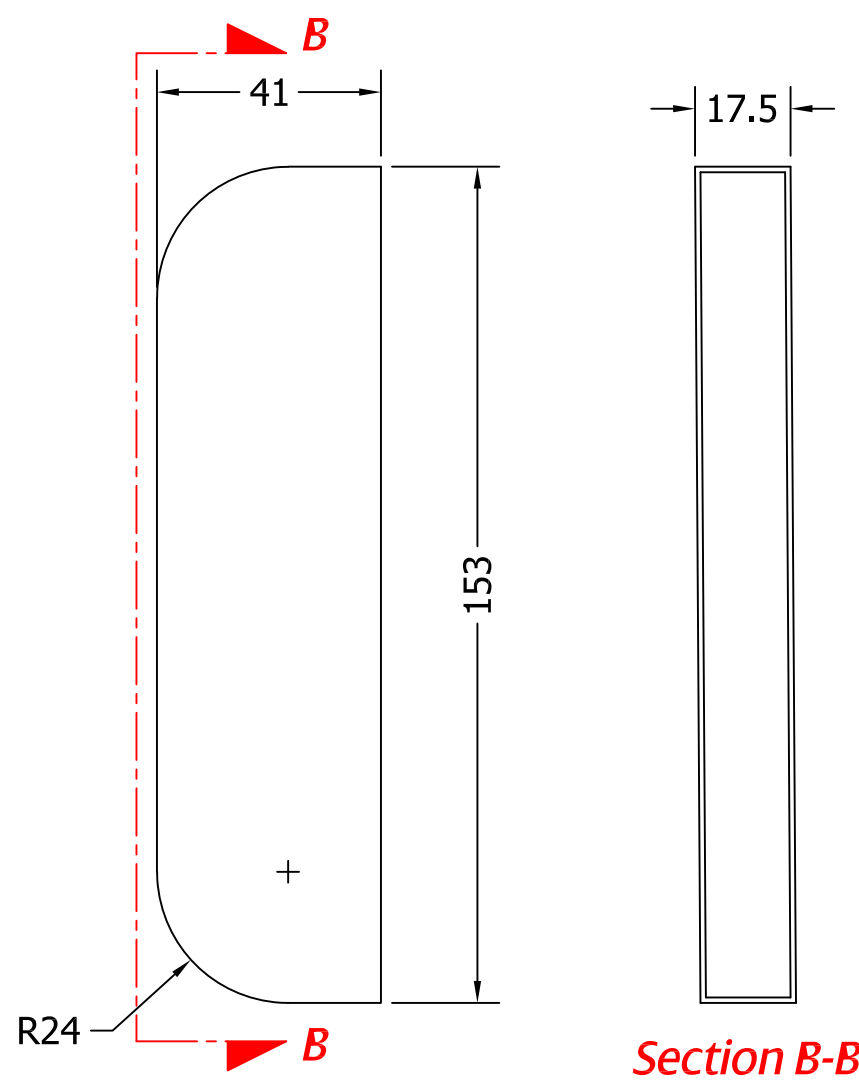

Top/Bottom Gearbox Cover

Section B-B

**COASTAL GROUP**  
Innovating & upgrading the style, performance & longevity of external doors & windows globally

Global House, Bojea Industrial Estate, Trethowel, St Austell, PL25 5RJ  
 Telephone | 01726 871725 - Fax | 01726 871731  
 Email | sales@coastal-group.com - Web | www.coastal-group.com

Drawing Reference:  
**Coastal Group**

Drawing Title:  
**Master Door Lock Gearbox Sleeves  
 MACO Sleeves**

Product Range:  
**For 55mm Backset**

Additional Info: For use with Master Door Lock  
 Universally Handed

Date Drawn: 28/03/2018  
 Drawn By: Phil Walklett  
 Part Number: **ML260-55-SLEEVE**  
 File Name: **CG-ML260-55-SLEEVE.dwg**  
 Revision: **A**  
 Drawing Scale: Not to Scale  
 Sheet Number: 1 of 1

**THIRD ANGLE PROJECTION**  
 This drawing and specification are the property of Coastal Group, they are issued in strict confidence and shall not be reproduced, copied or used without written permission.