

While every attempt has been made to ensure the accuracy and completeness of the information in this document some typographical or technical errors may exist. Blu Performance cannot accept responsibility for customers' losses resulting from the use of this document. Please also note that this drawing / design is subject to change without prior notice in accordance with our policy of continual product development. This drawing / design contains proprietary information that is protected by copyright and is property of Blu Performance. Blu Performance is at the leading edge in joinery hardware, customer care and quality are at the core of everything we do, you can be confident that a call to Blu will be the only call you need for all your joinery hardware needs.

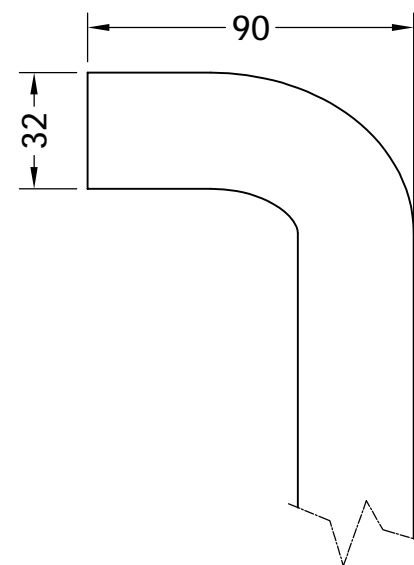

Section A-A

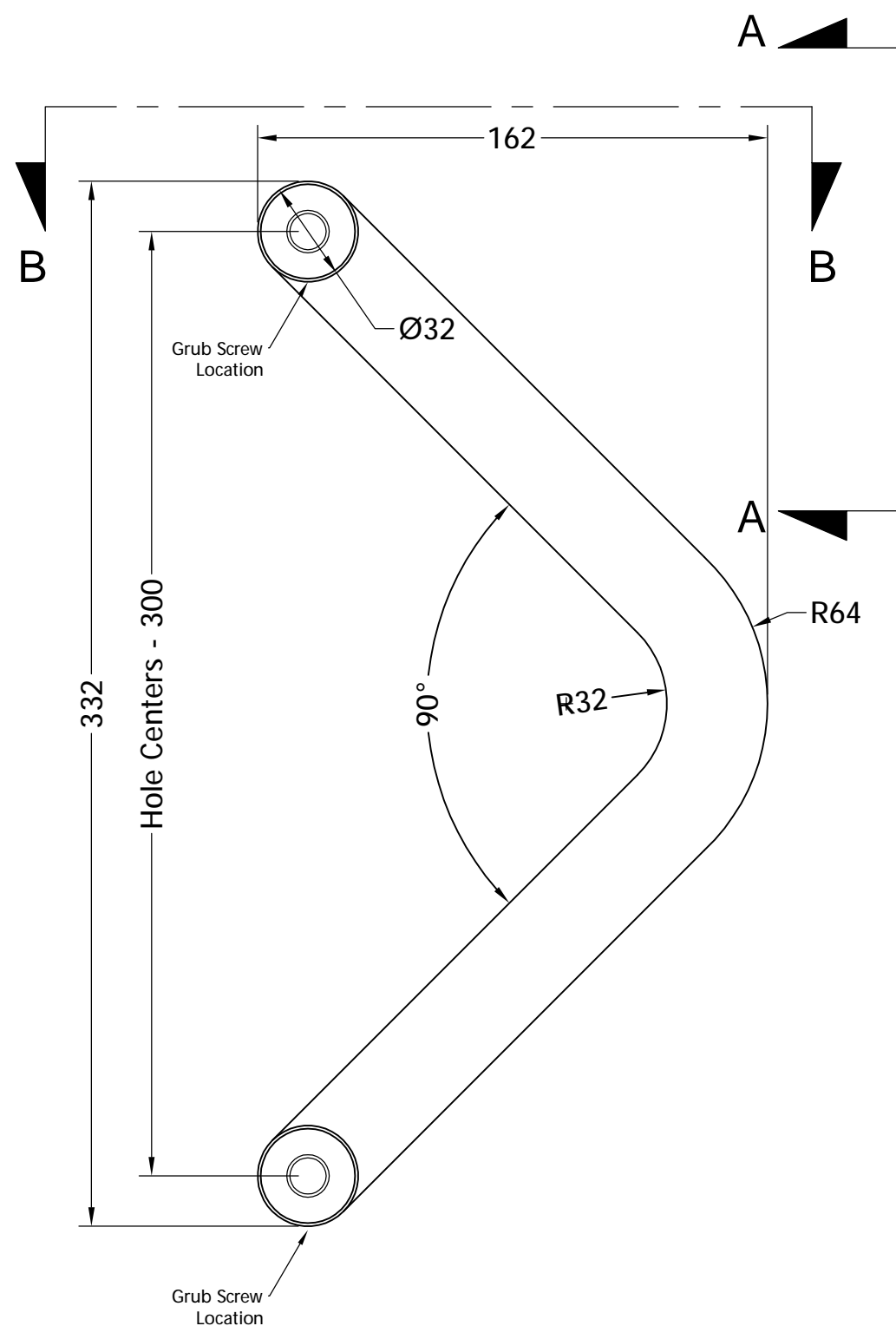
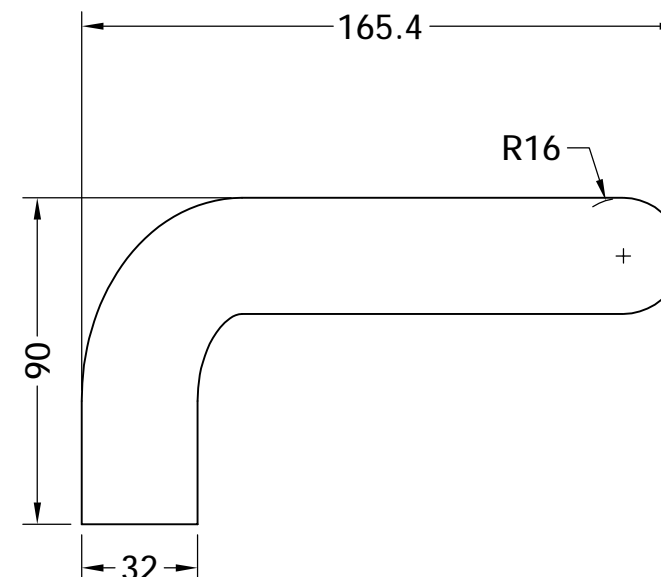

Section B-B



Plastic Pads



Fixing Sleeves

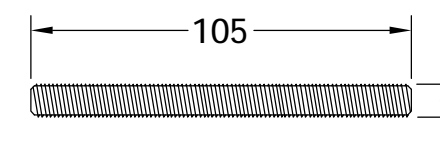

To suit up to 70mm thick doors.

Fixing Bolts



3mm Allen Key

WHATS INCLUDED IN THE BOX	
QTY	DESCRIPTION
1	EXTERNAL HALF MOON PULL HANDLE
1	INTERNAL HALF MOON PULL HANDLE
4	PLASTIC PADS
2	FIXING SLEEVES
2	FIXING BOLTS
1	3mm ALLEN KEY

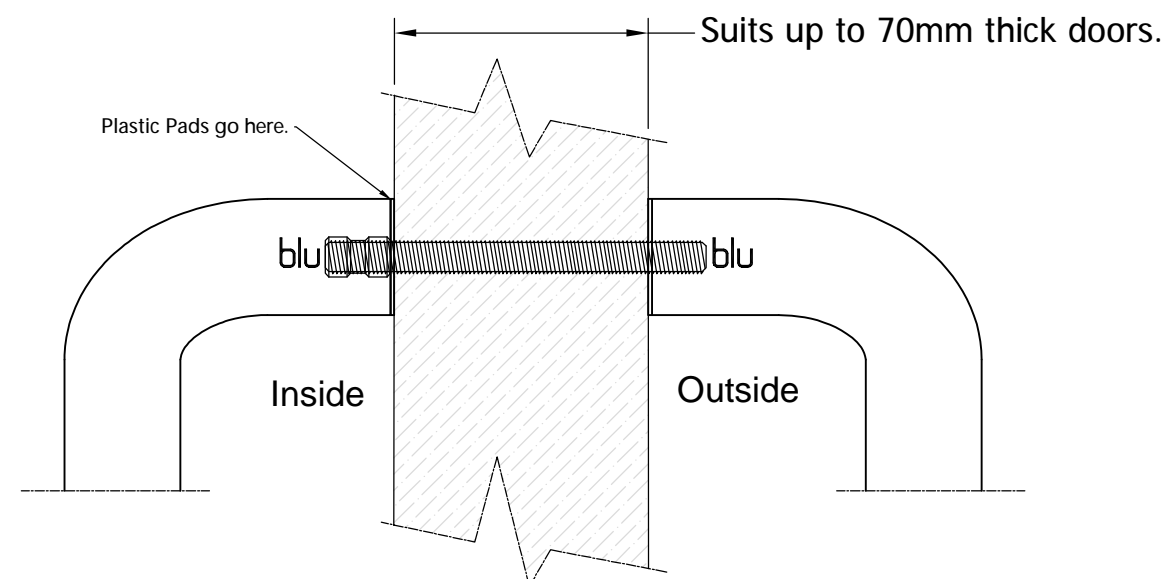

Assembled View (Back to Back Fix)



Global House
Bojea Industrial Estate
Trethowel, St Austell
Cornwall, PL25 5RJ

t | 01726 871025 f | 01726 871731
e | sales@blu-performance.com
w | www.blu-performance.com

Customer Reference:

blu Performance

Drawing Title:	300mm Half Moon Pull Handle Back to Back Fixing
Product Range / Project Reference	

Product Range / Project Reference

HAB22-300-BB-SSS

Other Information:	Suits up to door thickness of 70mm.
--------------------	-------------------------------------

Date Drawn:	18/07/2016
-------------	------------

Drawn By:	Phil Walklett
-----------	---------------

Drawing Number:
BP-HAB22-300-BB-SSS.dwg

THIRD ANGLE PROJECTION



This drawing and specification are the property of Coastal Group, they are issued in strict confidence and shall not be reproduced, copied or used without written permission.

Scale: NONE

Sheet: 1 of 1