

While every attempt has been made to ensure the accuracy and completeness of the information in this document some typographical or technical errors may exist. Blu Performance cannot accept responsibility for customers' losses resulting from the use of this document. Please also note that this drawing / design is subject to change without prior notice in accordance with our policy of continual product development. This drawing / design contains proprietary information that is protected by copyright and is property of Blu Performance. Blu Performance is at the leading edge in joinery hardware, customer care and quality are at the core of everything we do, you can be confident that a call to Blu will be the only call you need for all your joinery hardware needs.

### Revision History

Revision	Description	Drawn By	Date	Approved By
A	Released	Phil Walklett	11/07/2016	PW / BD

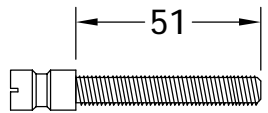
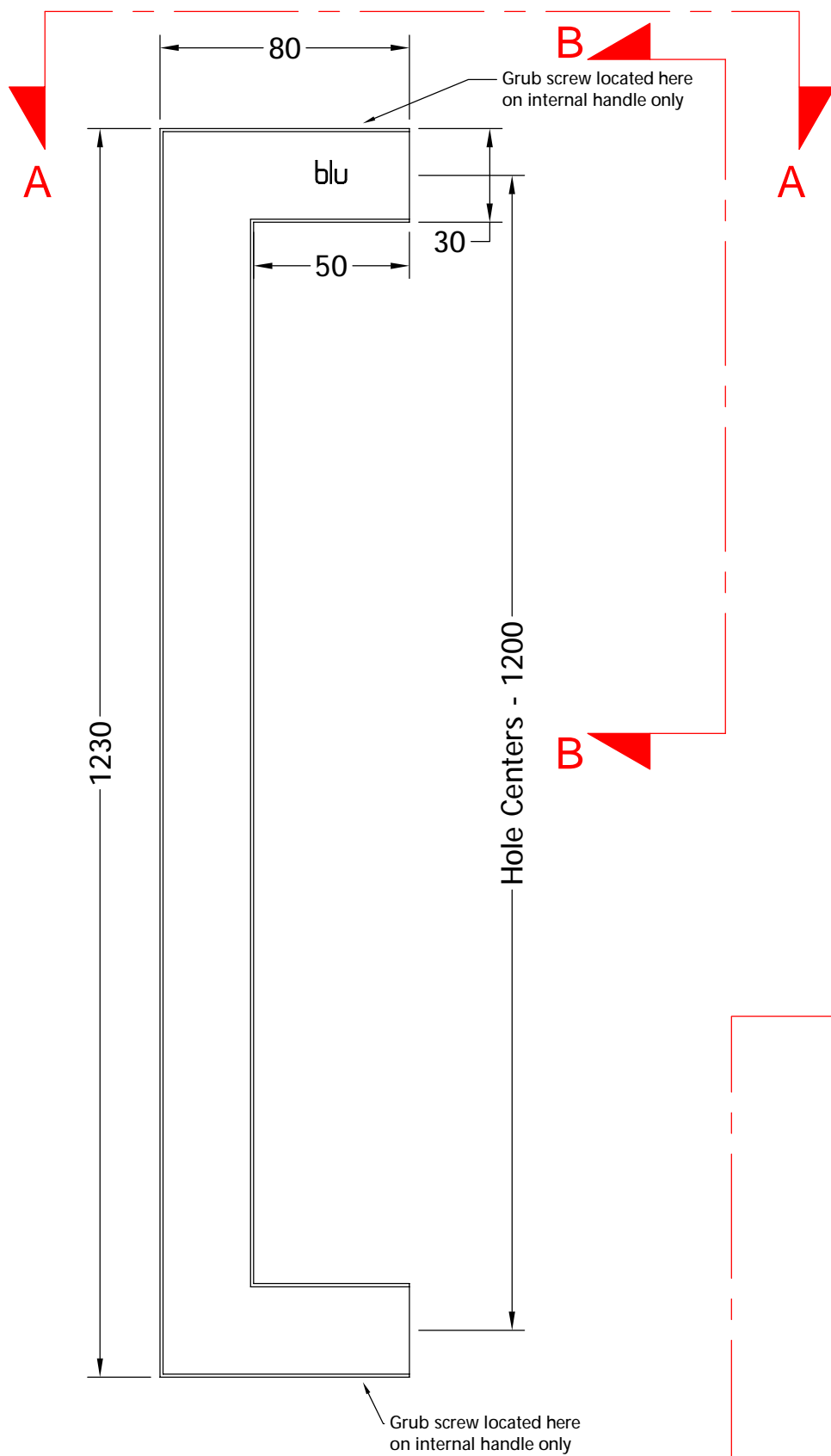

Please Note:  
Sometimes fixings that are used for transport are not 316 Stainless Steel and are there for transportation means only, please discard these fittings and use the 96mm bolts that are provided in the fixing packs when fixing to door.

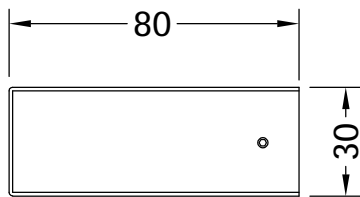

Section A-A

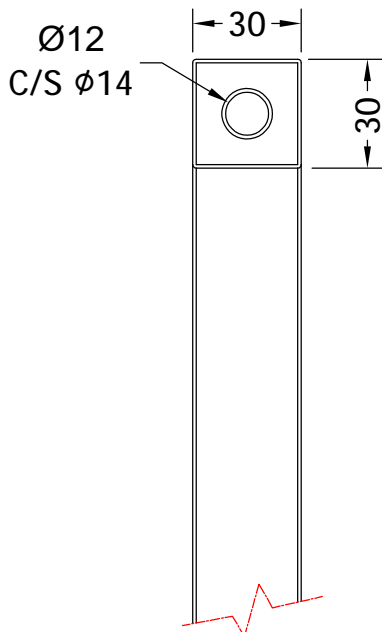

Section B-B

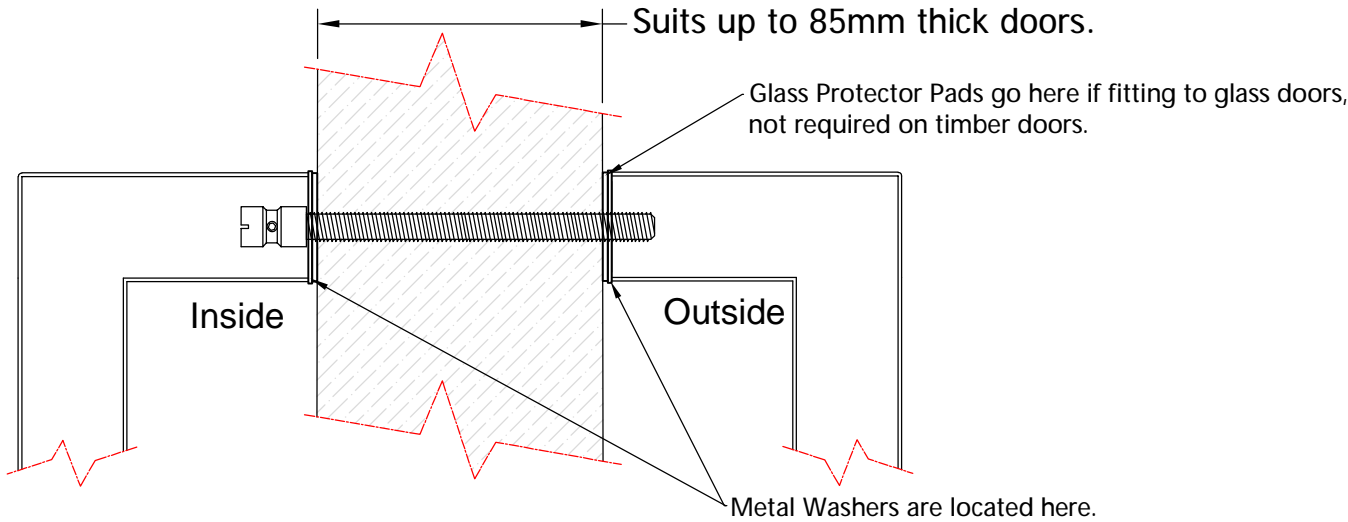

Assembled View (Back to Back Fix)

Glass Protector Pads  
Not Required on Timber Doors

Metal Washers

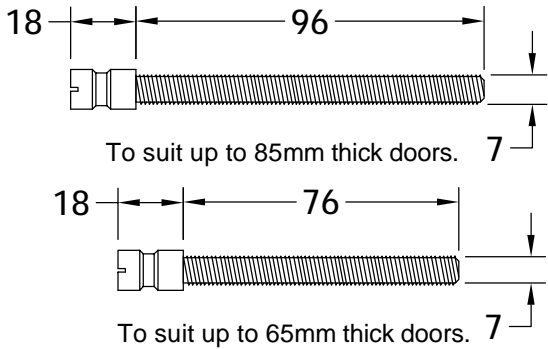

Fixing Bolts

3mm Allen Key

### WHATS INCLUDED IN THE BOX

QTY	DESCRIPTION
1	EXTERNAL SQUARE MITRE PULL HANDLE
1	INTERNAL SQUARE MITRE PULL HANDLE
4	GLASS PROTECTOR PADS
4	METAL WASHERS
2	96mm FIXING BOLTS
2	76mm FIXING BOLTS
1	3mm ALLEN KEY

Global House  
Bojea Industrial Estate  
Trethowel, St Austell  
Cornwall, PL25 5RJ  
t | 01726 871025 f | 01726 871731  
e | sales@blu-performance.com  
w | www.blu-performance.com

Customer Reference:

**blu Performance**

Drawing Title:  
**1200mm Square Mitre Pull Handle  
Back to Back Fixing**

Product Range / Project Reference  
**HAB4-1200-BB-SSS**

Other Information: **Suits up to door thickness of 85mm.**

Date Drawn: **11/07/2016**

Drawn By: **Phil Walklett**

Drawing Number:  
**BP-HAB4-1200-BB-SSS.dwg**

Revision:  
**A**

THIRD ANGLE PROJECTION

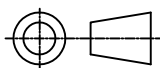

This drawing and specification are the property of Coastal Group, they are issued in strict confidence and shall not be reproduced, copied or used without written permission.

Scale: **NONE**

Sheet: **1 of 1**