

REVISION HISTORY			
Revision	Description	Drawn	Date
A	Release	PW	08/10/18

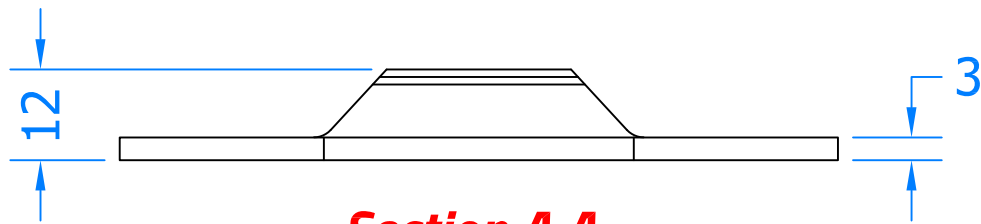
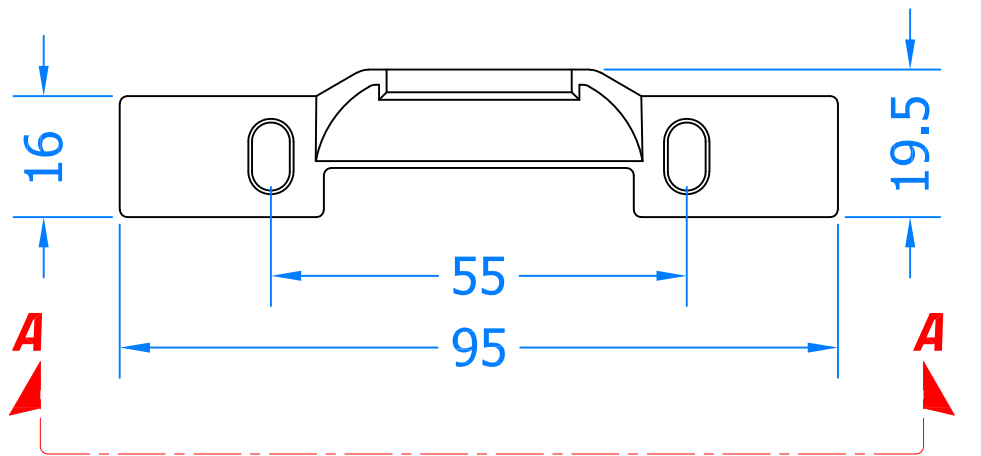

Section A-A

 **Innovating & Upgrading the Style,
Performance & Longevity of
External Doors & Windows Globally.**

Coastal Specialist Ironmongery Ltd.
Global House, Bojea Industrial Estate, Trethowel, St Austell, PL25 5RJ
t | 01726 871725 - f | 01726 871731 - e | sales@coastal-group.com
w | www.coastal-group.com

Drawing Title: LCS20 95mm Locking Claws	
Product Range: Window Hardware	
Additional Info: Sold as Pack of 4	
Date Drawn:	08/10/2018
Drawn By:	Phil Walklett
Part Number:	LCS20
File Name:	CG-LCS20.dwg
Revision:	A
Drawing Scale:	1:1@A3
Sheet Number:	1 of 1

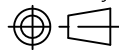
THIRD ANGLE PROJECTION
 This drawing and specification are the property of Coastal, they are issued in strict confidence and shall not be reproduced, copied or used without written permission.