

Revision History

| Revision | Description | Drawn By | Date |
|----------|-------------------------------|----------|----------|
| A | Released | PW | 20/6/17 |
| B | Added additional routing prep | PW | 30/10/18 |

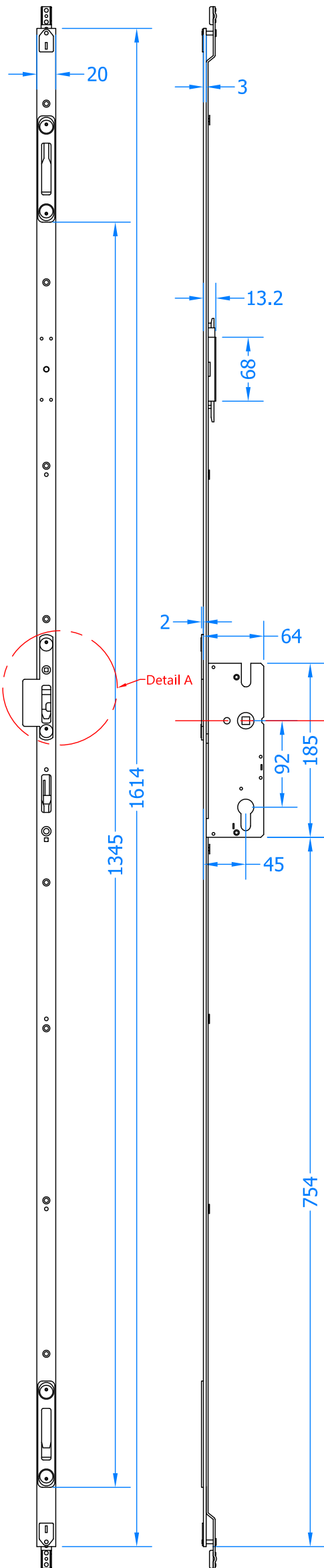

Routing Preperation

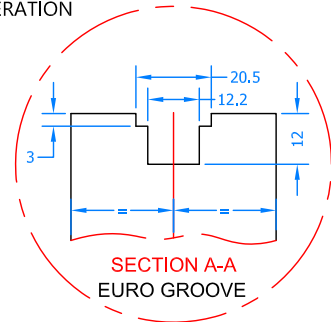
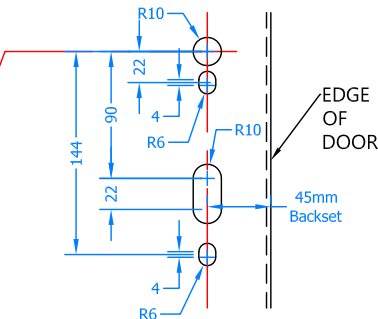
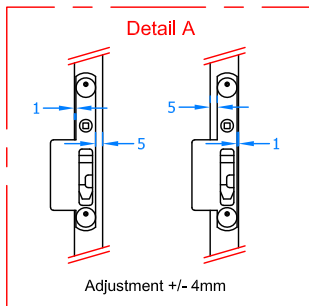
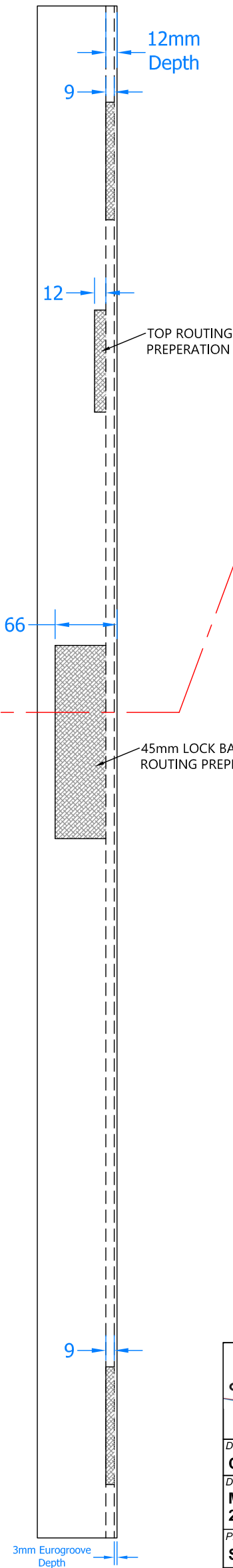
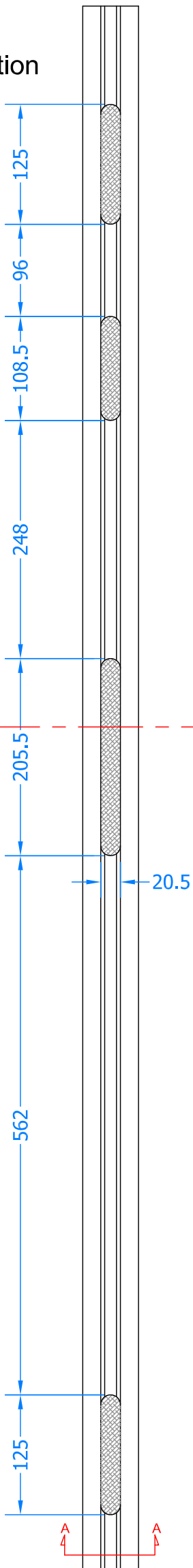



Global House, Bojea Industrial Estate, Trethowel, St Austell, PL25 5RJ
telephone | 01726 871724 - fax | 01726 871731
email | sales@coastal-group.com - web | www.coastal-group.com

Drawing Reference:

Coastal Group

Drawing Title:

**ML26S - 45mm Backset
22mm Centres**

Product Range:

Slave Door Lock

Additional Info:

92mm Lock Centres, 20mm Faceplate
LH Shown, RH Opposite

Date Drawn:

03/08/2017

Drawn By:

Phil Walklett

Part Number:

ML26S-45-22-SV

File Name:

CG-ML26S-45-22-SV.dwg

Revision:

A

Drawing Scale:

NONE

Sheet Number:

1 of 1

THIRD ANGLE PROJECTION



This drawing and specification are the property of Coastal Group, they are issued in strict confidence and shall not be reproduced, copied or used without written permission.