

While every attempt has been made to ensure the accuracy and completeness of the information in this document some typographical or technical errors may exist. Coastal Group cannot accept responsibility for customers' losses resulting from the use of this document. Please also note that this drawing / design is subject to change without prior notice in accordance with our policy of continual product development. This drawing / design contains proprietary information that is protected by copyright and is property of Coastal Group. Coastal Group is at the leading edge in joinery hardware, customer care and quality are at the core of everything we do, you can be confident that a call to Coastal will be the only call you need for all your joinery hardware needs.

| Revision History | | | | |
|------------------|-----------------------------|----------|---------|-------------|
| Revision | Description | Drawn By | Date | Approved By |
| A | Released | PW | 3/5/16 | BD |
| B | Moved centre hole to 21.5mm | PW | 30/5/17 | BD |

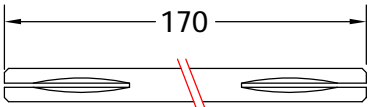

8x8x170 Spindle

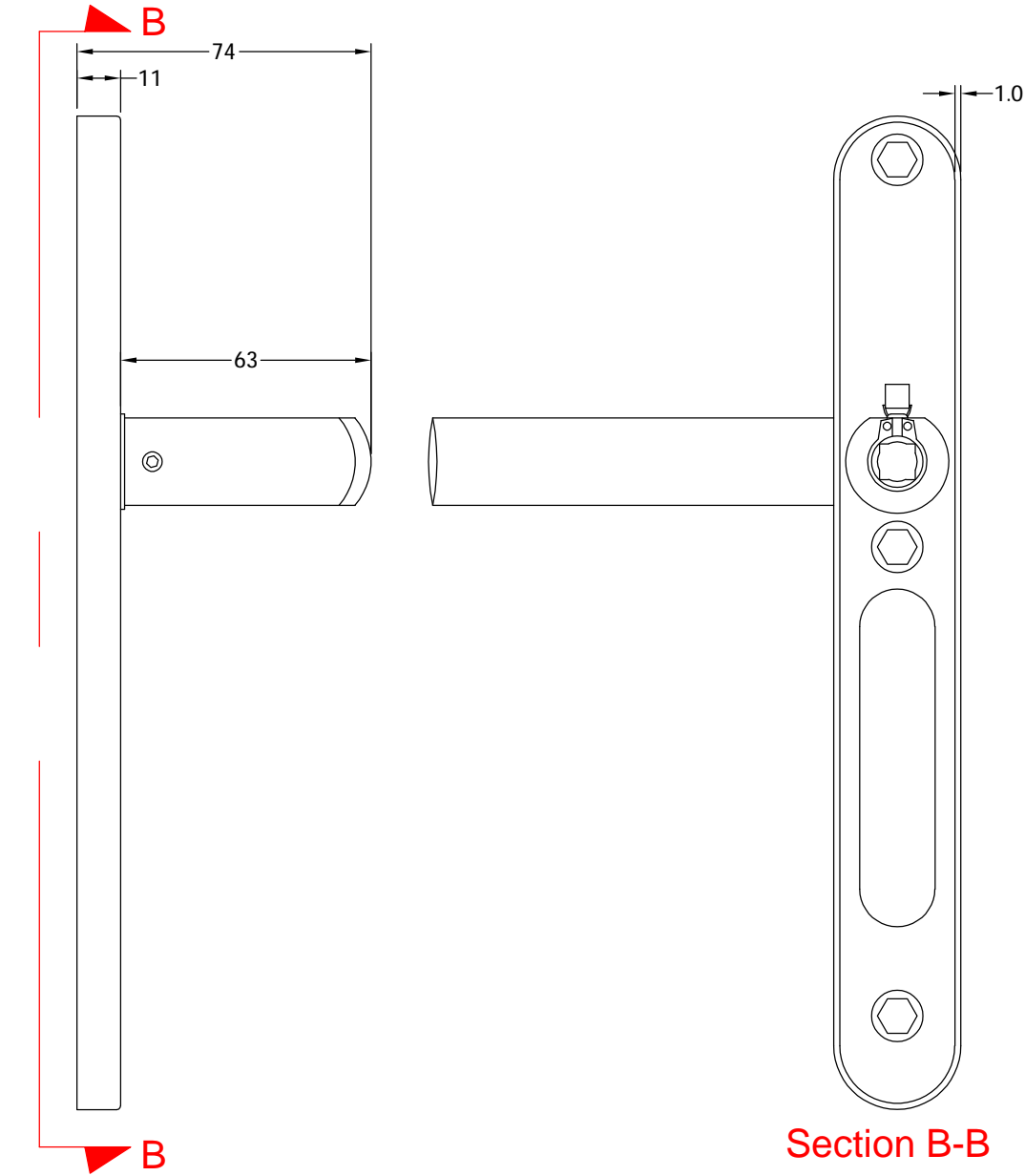
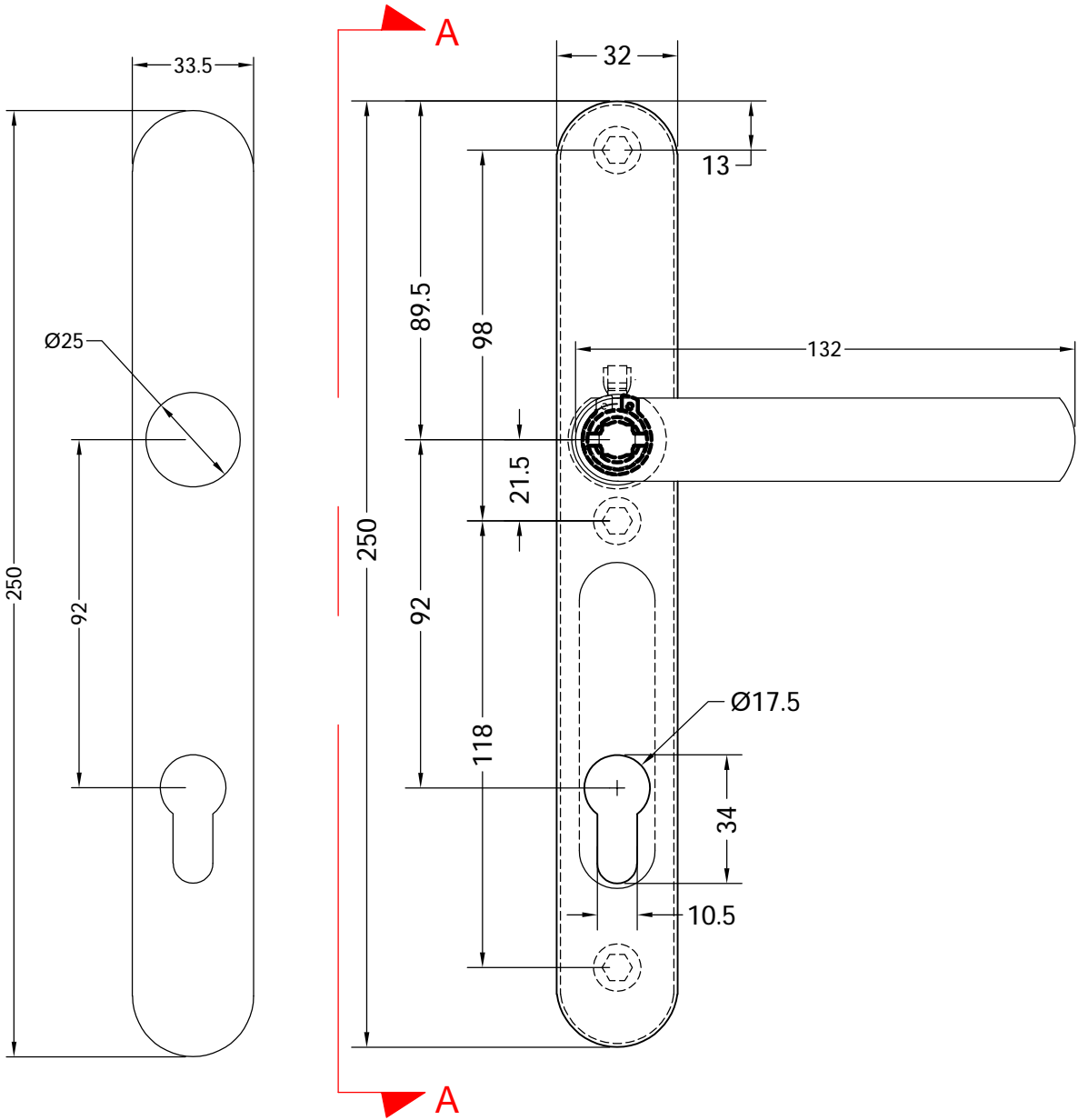
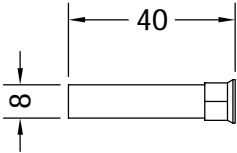

Bolt Receiver Sleeve

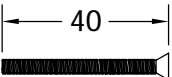

40mm Bolts

Suits Doors up to 60mm Thick

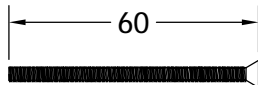

60mm Bolts

Suits Doors up to 80mm Thick

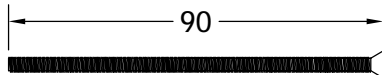

90mm Bolts (additional, not supplied)

Suits Doors up to 110mm Thick

These are available please quote code BLU-FX-10055



3mm Allen Key

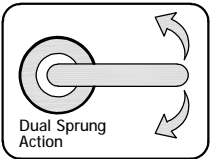

| WHATS INCLUDED IN THE BOX | |
|---------------------------|------------------------|
| QTY | DESCRIPTION |
| 2 | UNIVERSAL DOOR HANDLES |
| 3 | BOLT RECEIVER SLEEVES |
| 3 | 60mm FIXING BOLTS |
| 3 | 40mm FIXING BOLTS |
| 1 | 8 x 8 x 170mm SPINDLE |
| 1 | 3mm Allen Key |



Global House
Bojea Industrial Estate
Trethowel, St Austell
Cornwall, PL25 5RJ
t | 01726 871025 f | 01726 871731
e | sales@coastal-group.com
w | www.coastal-group.com

Customer Reference:

Coastal Group

Drawing Title:
**JR095
Multipoint Handle Set**

Product Range / Project Reference
Jigsaw 92mm Multipoint Door Handle

| | |
|--------------------|---------------|
| Other Information: | N/A |
| Date Drawn: | 30/05/2017 |
| Drawn By: | Phil Walklett |
| Drawing Number: | CG-JR095.dwg |
| Revision: | B |

THIRD ANGLE PROJECTION



This drawing and specification are the property of Coastal Group, they are issued in strict confidence and shall not be reproduced, copied or used without written permission.

Scale: None

Sheet: 1 of 1