

While every attempt has been made to ensure the accuracy and completeness of the information in this document some typographical or technical errors may exist. Coastal Group cannot accept responsibility for customers' losses resulting from the use of this document. Please also note that this drawing / design is subject to change without prior notice in accordance with our policy of continual product development. This drawing / design contains proprietary information that is protected by copyright and is property of Coastal Group. Coastal Group is at the leading edge in joinery hardware, customer care and quality are at the core of everything we do, you can be confident that a call to Coastal will be the only call you need for all your joinery hardware needs.

Revision History

Revision	Description	Drawn By	Date	Approved By
A	Released	PW	23/3/16	BD

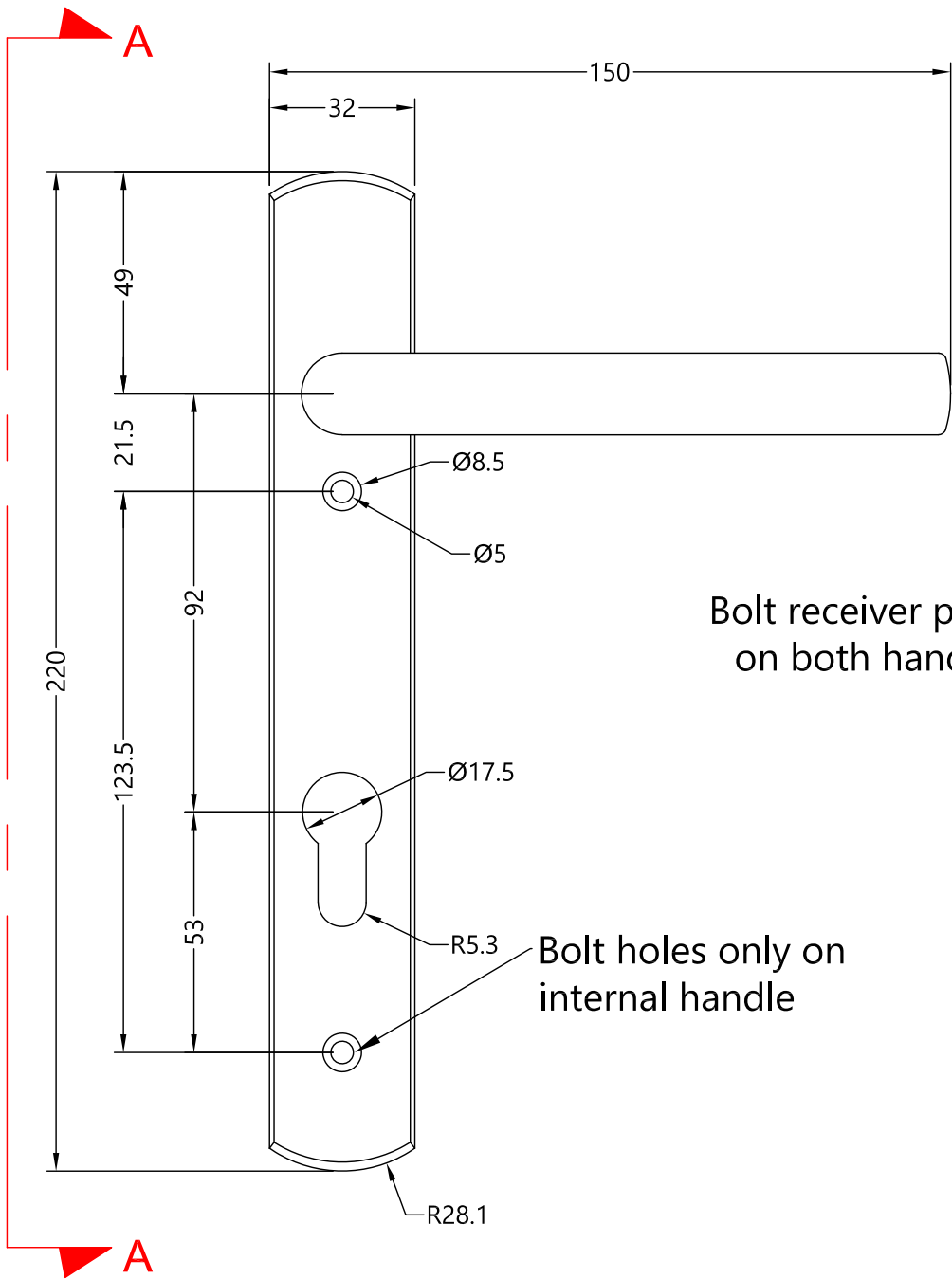

Bolt receiver pegs
on both handles

Bolt holes only on
internal handle

Grub Screw

Section B-B

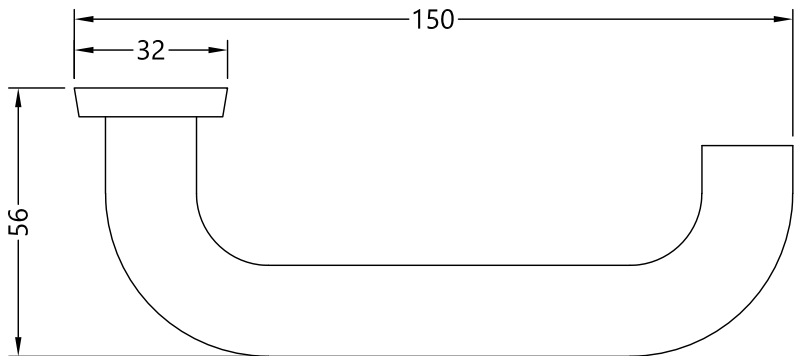

Section C-C



Global House
Bojea Industrial Estate
Trethowel, St Austell
Cornwall, PL25 5RJ
t | 01726 871025 f | 01726 871731
e | sales@coastal-group.com
w | www.coastal-group.com

Customer Reference:

Coastal Group

Drawing Title:
**CMNP41-SSS
Multipoint Handle Set**

Product Range / Project Reference
CoMarine 92mm Triangular Return

Other Information: FD30/60 & FD120/240

Date Drawn: 23/03/2016

Drawn By: Phil Walklett

Drawing Number:
CG-CMNP41_SSS.dwg

Revision:
A

THIRD ANGLE PROJECTION

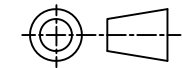

This drawing and specification are the property of Coastal Group, they are issued in strict confidence and shall not be reproduced, copied or used without written permission.

Scale: NONE

Sheet: 1 of 1