

TOP VIEW - OPEN POSITION

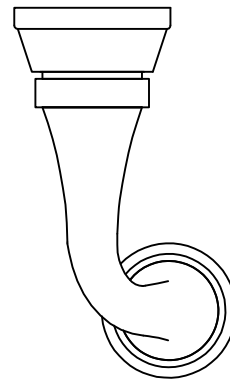

Section A-A
SIDE VIEW - LOCKED POSITION

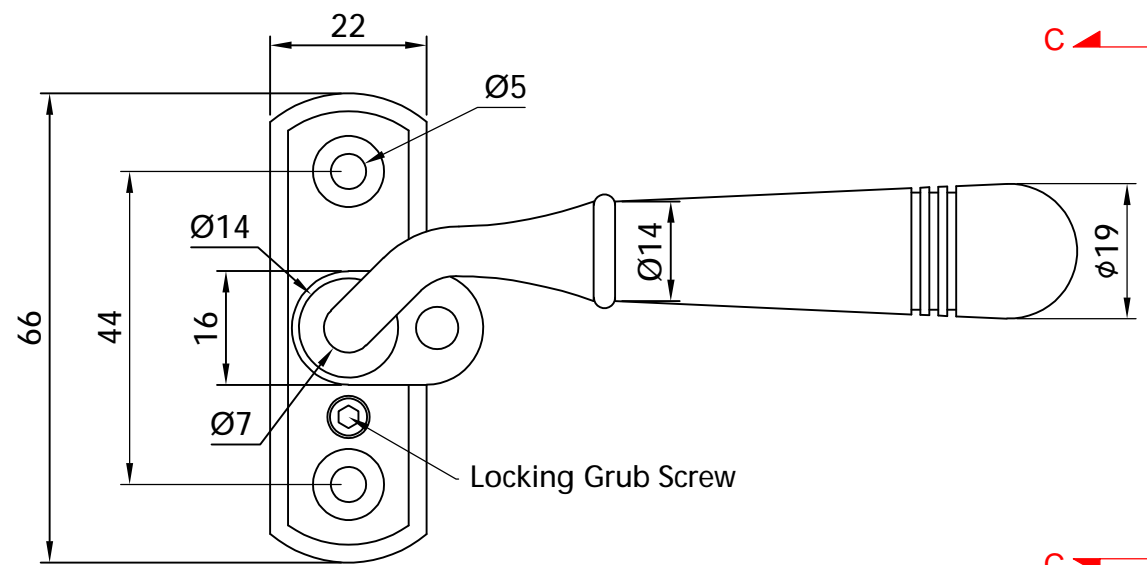

Section B-B
FRONT VIEW - OPEN POSITION

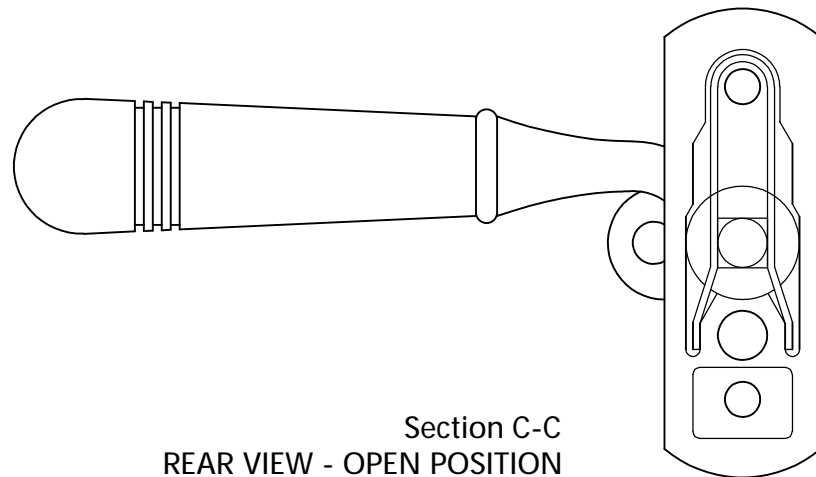

Section C-C
REAR VIEW - OPEN POSITION

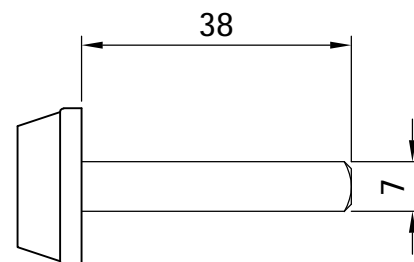

SPINDLE DIMENSIONS

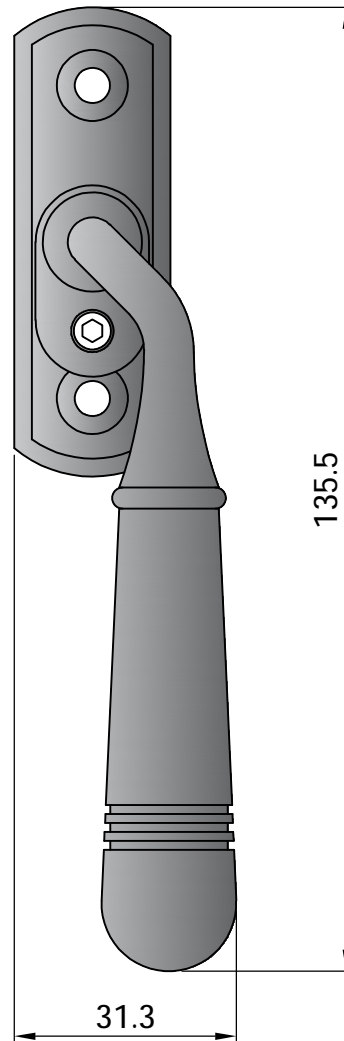

FRONT VIEW - LOCKED POSITION

Revision History			
Revision	Description	Drawn By	Date
A	Release	PW	14/9/16

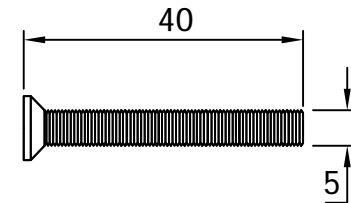

M5 x 40 BOLT

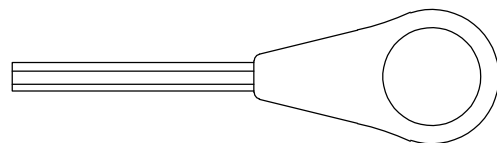

4mm Allen Key

WHATS INCLUDED IN THE BOX	
QTY	DESCRIPTION
1	TBH020 RH ESPAG HANDLE
2	40MM M5 X 40MM FIXING BOLTS
1	4MM GRUB SCREW ALLEN KEY



Global House
Bojea Industrial Estate
Trethowel, St Austell
Cornwall, PL25 5RJ
t | 01726 871724
f | 01726 871731
sales@blu-performance.com
www.blu-performance.com

Drawing Reference:
blu Performance

Drawing Title:
**RH - Opera Window Handle
Sprung Lever - 316 Stainless Steel**

Product Range:
TBH020-RH-SSS

Additional Info: Right Hand Handle

Date Drawn: 14/09/2016

Drawn By: Phil Walklett

Part Number: TBH020-RH-SSS

File Name: BP-TBH020-RH-SSS.dwg

Revision: A

Drawing Scale: NONE

Sheet Number: 1 of 1

THIRD ANGLE PROJECTION

This drawing and specification are the property of blu Performance, they are issued in strict confidence and shall not be reproduced, copied or used without written permission.