

# FITTING INSTRUCTION

## Lever Door Handle on Backplate

REG095 • THB095 • PER095

LIT-FG-095

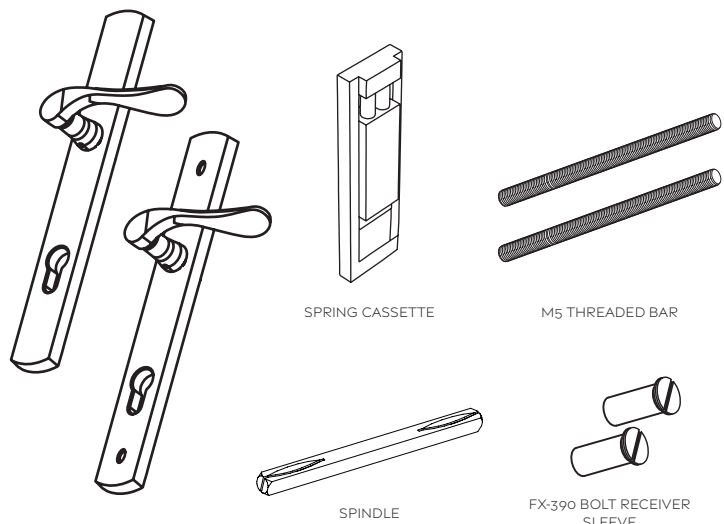

**1**

Drill out for spindle, euro cylinder and handle fixing points.

- Spindle centre line hole to Euro Profile hole = **92mm** centre
- Spindle centre line hole to top M5 threaded fixing hole = **74.5mm** centre
- Top M5 threaded fixing hole to bottom M5 threaded fixing hole = **221mm** centre

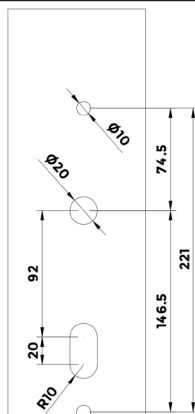

**STEP 2**

Take the external handle set and install the spring cassette with the stepped part facing towards the backplate.

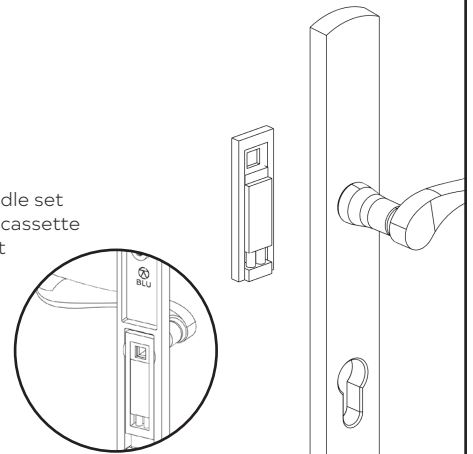

**STEP 3**

Slide the spindle into the lever as shown.

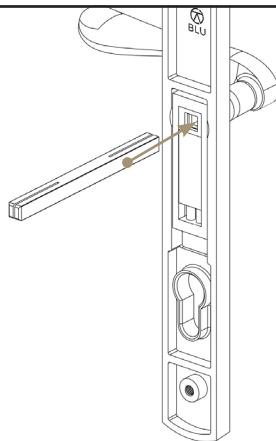

**STEP 4**

The dish cut side will need to be in either horizontal or vertical position in order to align with the grub screw on the lever.

This instruction is based on a handle using a spring cassette and has a split type spindle. It is important to make sure the installation is correct to minimise any 'sagging' of the lever when installed, this also secures the handle to the spindle so the operation is smooth and true.

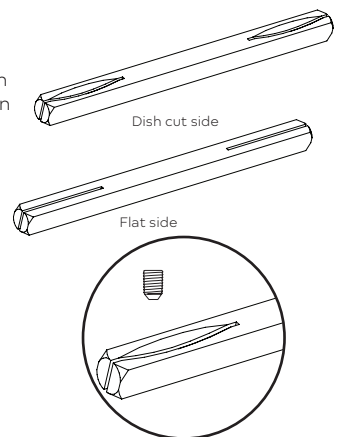

**STEP 5**

Depending on where the lever grub screw is located (this can be either in the side of the lever or in the bottom) make sure the dish cut side on the spindle is on the same face as shown.

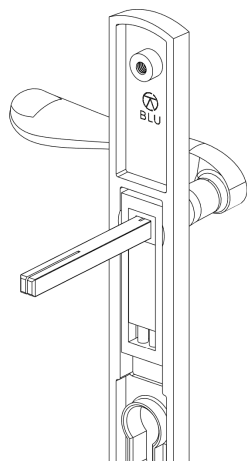

**STEP 6**

Make sure the dish cut side on the spindle is lined up to the grub screw, failure to do this might lead to the grub screw becoming loose which may have an impact on the operation.

This means that when the grub screw is tightened up the point then 'splays' the spindle apart ever so slightly causing the spindle to grip in the shaft securely. This will stop the grub screw from coming undone after use.



**STEP 7**

Once the position of the split is confirmed, tighten the grub in the lever handle screw using the Allen key.

Taking the appropriate Allen key, tighten by hand the grub screw to secure this into the spindle (do not overtighten as this could damage the head of the grub screw).

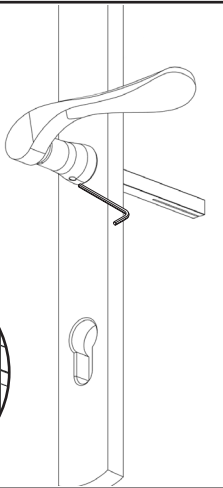
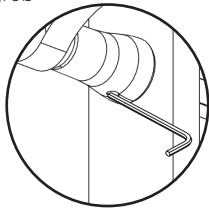
**STEP 8**

Take the M5 threaded bars and screw these into the external backplate until tight.

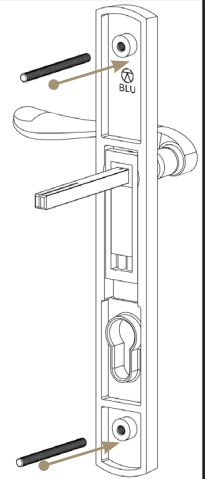
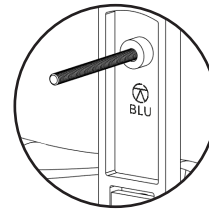
**STEP 9**

Take the internal handle set. Install the spring cassette with the stepped part facing towards the backplate, as in step 2.

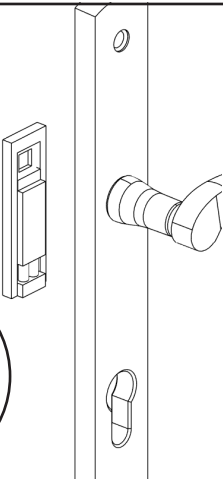
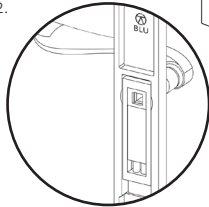
**STEP 10**

Take the external handle set and install in the door until it sits flush with the door stile.

The spindle and threaded bars will pass through the machined holes.

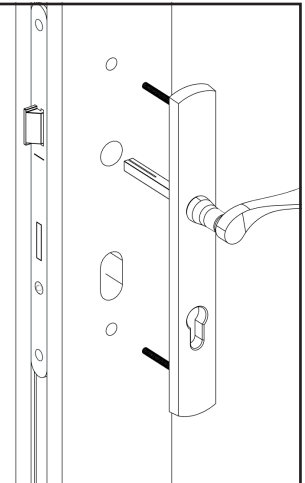
**STEP 11**

While holding the external handle set in place, take the internal handle set and line up the spindle hole, passing this through the spring cassette and into the lever.

Push firmly until the internal door handle sits flush with the door stile\*.

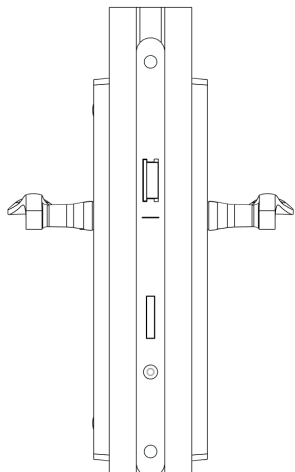

\* If the spindle and threaded bars are too long, preventing the internal handle set from sitting flush to the door, shorten by cutting the spindle.

**Please note:** Do not cut too short. If a significant reduction is needed, cut equally from both ends. Avoid cutting the split element.

**STEP 12**

Locate the FX-390 bolt receiver sleeve through the holes in the internal handle.

Tighten with a flat head screwdriver (do not use an electric screwdriver to avoid over-tightening) to secure the handle in place.

**STEP 13**

Tighten the grub screw in the internal lever handle to secure the spindle.

This will splay the internal spindle and ensure a solid fix lever.

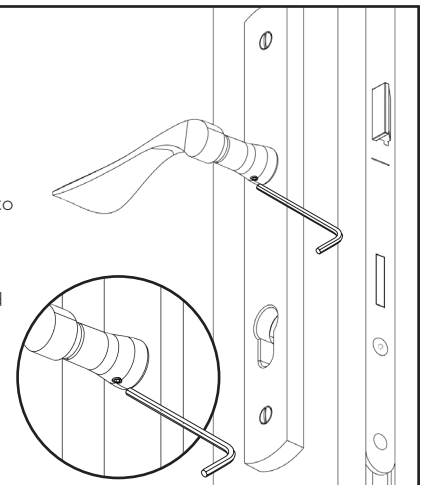

**STEP  
14**

Once the other lever is fitted and screwed back tightly to the door, the final step is to tighten the grub screw, so it grips the spindle as shown above. This means the installation has been carried out correctly.

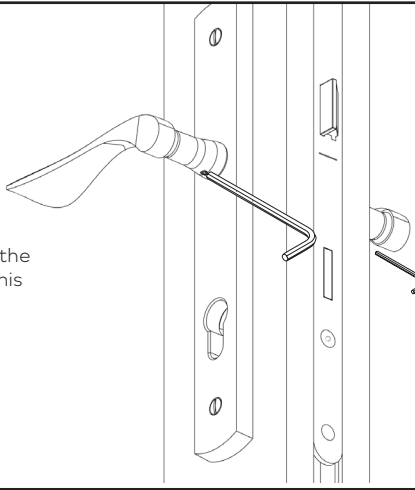

## Troubleshooting

- If your handle is too tight to open and close, try loosening the grub screw in the handle to release the internal spindle.
- If the backplate becomes loose, simply tighten the FX-390 sleeves.
- If the levers start to drop over time, check the grub screws are tight in both areas; these can become loose over time.
- If the spring action becomes less pronounced, you can replace the spring cassette in the internal/external handle. Simply contact [sales@coastal-group.com](mailto:sales@coastal-group.com) to order your new spring cassette.