

This drawing and specification are the property of the Coastal Specialist Ironmongery Ltd.  
They are issued in strict confidence and shall not be reproduced, copied or used without written permission.

### REVISION HISTORY

Revision	Description	Drawn	Date
A	Release	PW	7/8/18

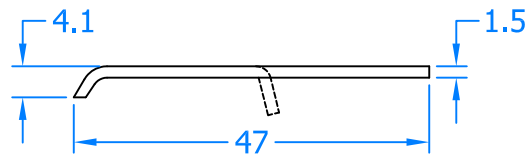

**Section B-B**

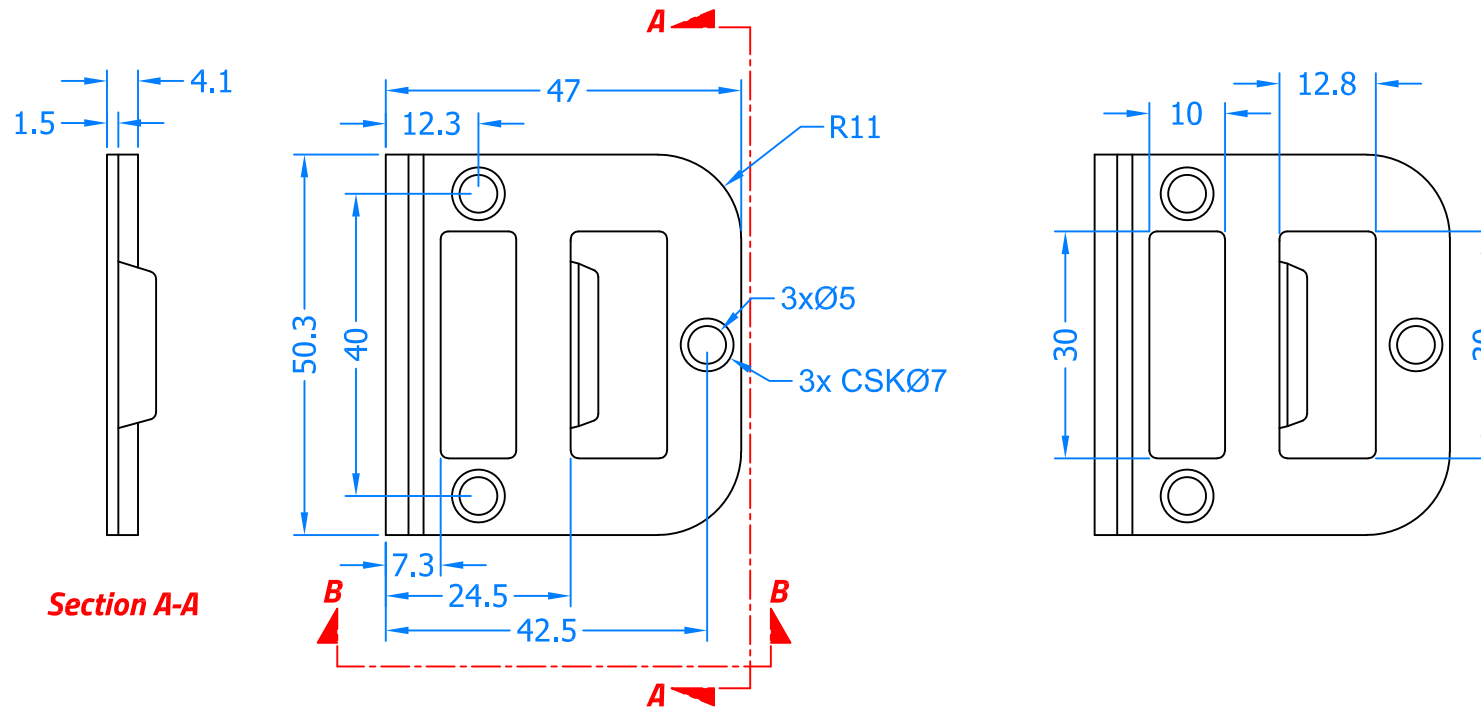

**Section A-A**



*Innovating & Upgrading the Style,  
Performance & Longevity of  
External Doors & Windows Globally.*

**Coastal Specialist Ironmongery Ltd.**  
Global House, Bojea Industrial Estate, Trethowel, St Austell, PL25 5RJ  
t | 01726 871725 - f | 01726 871731 - e | sales@coastal-group.com  
w | www.coastal-group.com

Drawing Title:  
**FCK100  
Flat Night Vent Keep**

Product Range:  
**Tritus Flush Side/Top Hung**

Additional Info:

Date Drawn:	07/08/2018
Drawn By:	Phil Walklett
Part Number:	FCK100-SV
File Name:	CG-FCK100-SV.dwg
Revision:	A
Drawing Scale:	1:1@A4
Sheet Number:	1 of 1

THIRD ANGLE PROJECTION  This drawing and specification are the property of Coastal, they are issued in strict confidence and shall not be reproduced, copied or used without written permission.