

GLACE RANGE

CLAW FASTENER - SECURITY

Product Code: GL45

LIT-DC-GL45

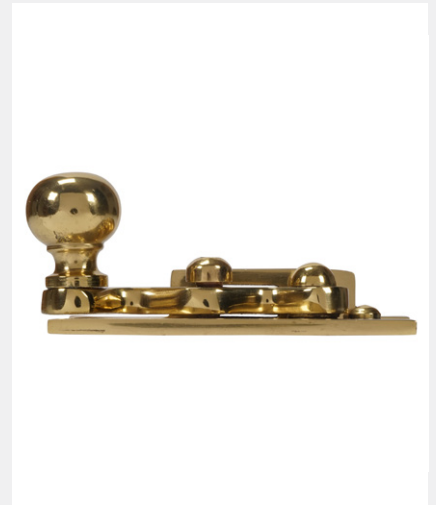

Solid Brass Range

- High quality security Claw Fastener for sliding sash windows
- A high security version successfully PAS24 Approved and used on our Part Q Test
- Lockable for enhanced security
- A more decorative alternative to the Fitch Fastener
- Designed to pull the top and bottom meeting rails together



COASTAL

Shaping the future.

T 01726 871 025 E sales@coastal-group.com W coastal-group.com

© Coastal Specialist Ironmongery Ltd 2021

Side Profile

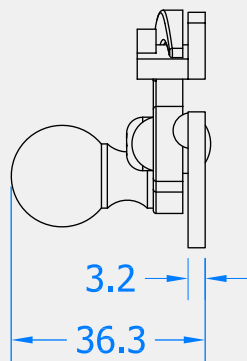

Top Profile

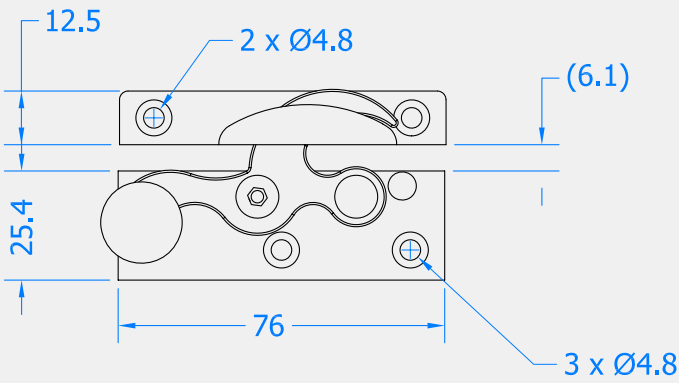

Visit www.coastal-group.com for CAD drawings

FINISHES:



SC
Satin Chrome



CP
Polished Chrome



BP
Polished Brass



ORZ
Oil Rubbed Bronze

PART NUMBER	PRODUCT DESCRIPTION	FINISH	UNITS
GL45-SC	Security lockable claw fastener	SC	Each
GL45-CP	Security lockable claw fastener	CP	Each
GL45-BP	Security lockable claw fastener	BP	Each
GL45-ORZ	Security lockable claw fastener	ORZ	Each