

This drawing and specification are the property of the Coastal Group.  
They are issued in strict confidence and shall not be reproduced, copied or used without written permission.

| Revision History |             |      |     |         |
|------------------|-------------|------|-----|---------|
| Revision         | Description | DRFT | CHK | Date    |
| A                | Release.    | PW   | BD  | 7/11/17 |

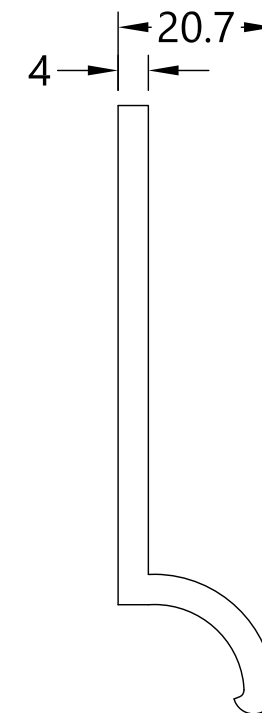

Section A-A

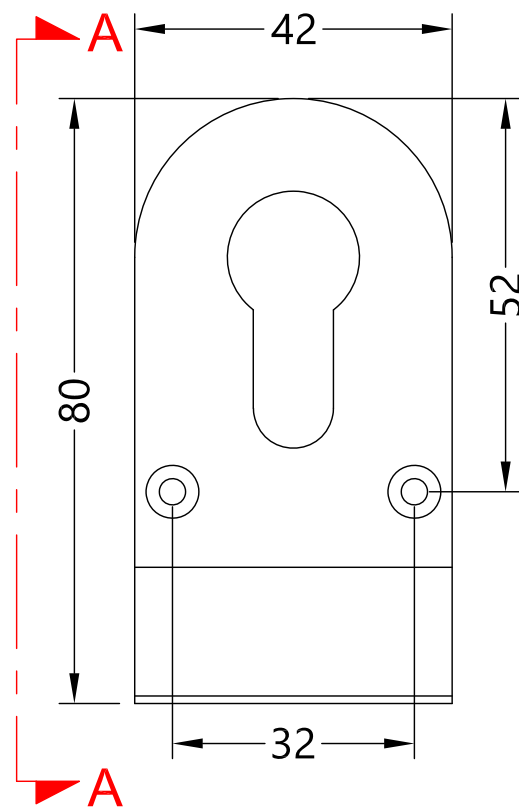
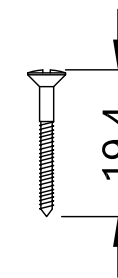

|  |  |
|--|--|
|  <p>Global House<br/>Bojea Industrial Estate<br/>Trehowel, St Austell<br/>Cornwall, PL25 5RJ</p> <p>t   01726 871025 f   01726 871731<br/>e   sales@coastal-group.com<br/>w   www.coastal-group.com</p> |  |
| Customer Reference:  |  |
| <b>Coastal Group</b>   |  |
| Drawing Title:<br><b>CP42</b><br><b>Classic Euro Cylinder Pull - Single Side</b>   |  |
| Product Range / Project Reference<br><b>Door Hardware</b>  |  |
| Other Information:   |  |
| Date Drawn: 08/11/2017   |  |
| Drawn By: Phil Walklett  |  |
| Drawing Number:<br>CG-CP42.dwg   | Revision:<br>A   |
| THIRD ANGLE PROJECTION<br>  | This drawing and specification are the property of Coastal Group, they are issued in strict confidence and shall not be reproduced, copied or used without written permission. |
| Scale: 1:1@A3  | Sheet: 1 of 1  |