

BLU RANGE

STRAIGHT SLIDE DOOR HANDLES - INLINE ROUND 'T' BAR

LIT-DC-IRPH

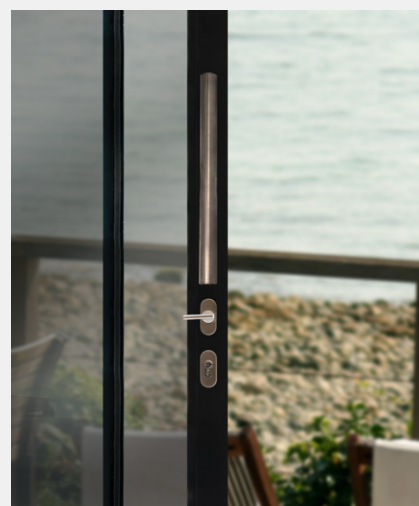

316 Marine Grade Stainless Steel Hardware Range

- Finest quality inline round 'T' bar pull handle
- Heavy duty 1.5mm stainless steel wall thickness for a superior feel & increased tensile strength
- Handle ends are CNC machined for a precision engineered consistent finish
- Part of a suited range of door & window hardware
- Designed with no middle stem to avoid conflicting with locking mechanism
- Manufactured from 316 Marine Grade Stainless Steel
- Ideal for use where corrosion levels are high, such as coastal environments and in acidic timber
- Lifetime guarantee

T 01726 871 025 E sales@coastal-group.com W coastal-group.com

© Coastal Specialist Ironmongery Ltd 2021



COASTAL

Shaping the future.

STRAIGHT SLIDE DOOR HANDLES - INLINE ROUND 'T' BAR

Front Profile

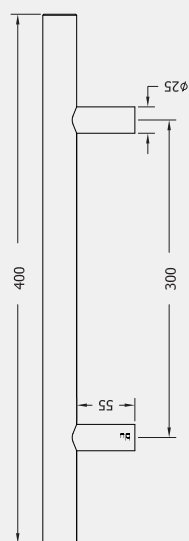

Front Profile

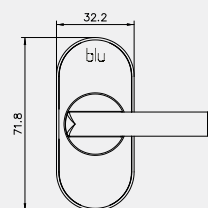

Side Profile

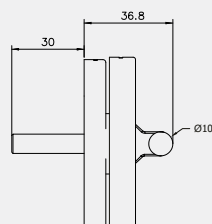

Front Profile

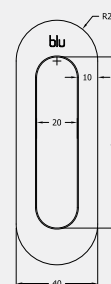

Side Profile

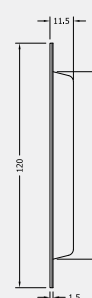

Front Profile

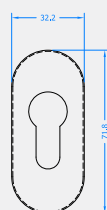

Side Profile

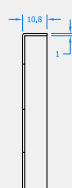

Visit www.coastal-group.com for CAD drawings

CONFIGURATIONS & FINISHES:



HAB2-400-BB-SSS

SSS

Satin Stainless Steel



HAB2-KIT-400-SA-SSS

SSS

Satin Stainless Steel



KM859-KIT-SING-SSS

SSS

Satin Stainless Steel



KM859-KIT-PAIR-SSS

SSS

Satin Stainless Steel

PART NUMBER	PRODUCT DESCRIPTION	FINISH	UNITS
HAB2-400-BB-SSS	400mm 'T' bar, back to back fix	SSS	Pair
HAB2-KIT-400-SA-SSS	400mm 'T' bar, secret fix, c/w fixings	SSS	Kit
KM859-KIT-SING-SSS	400mm 'T' bar, secret fix handle kit - oval rose	SSS	Kit
KM859-KIT-PAIR-SSS	400mm 'T' bar, back to back fix handle kit - oval rose	SSS	Kit



COASTAL

Shaping the future.