

# BLU RANGE DOOR KNOCKER

Product Code: DKB155

LIT-DC-DKB155

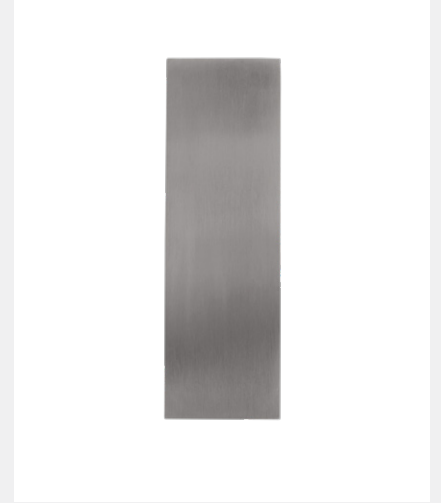

## *316 Marine Grade Stainless Steel Hardware Range*

- High quality solid stainless steel contemporary door knocker and strike plate
- Bolt-through security fixings
- Manufactured from 316 Marine Grade Stainless Steel
- Ideal for use where corrosion levels are high such as coastal environments and with acidic timber
- Part of a suited range of door and window hardware
- Lifetime guarantee



# COASTAL

*Shaping the future.*

Front Profile

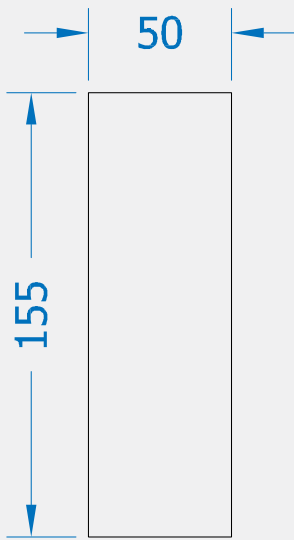

Side Profile

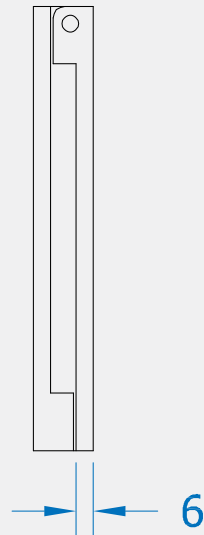

Top Profile

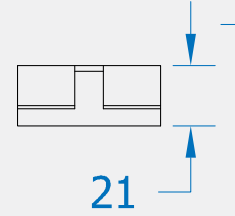

Visit [www.coastal-group.com](http://www.coastal-group.com) for CAD drawings

FINISHES:



SSS

Satin Stainless Steel

PART NUMBER	PRODUCT DESCRIPTION	FINISH	UNITS
DKB155-SSS	Door knocker	SSS	Each



**COASTAL**

*Shaping the future.*