

Drawing Revision History		
Revision	Description /Change	Date
A	Release	05/11/2021
B	Changed screw lengths to 40mm	3/4 /2023

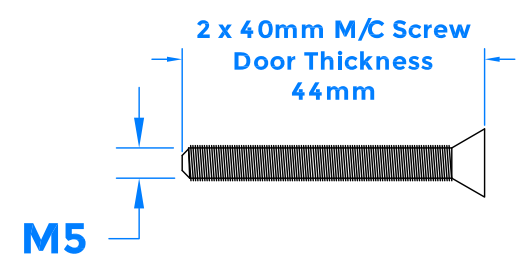

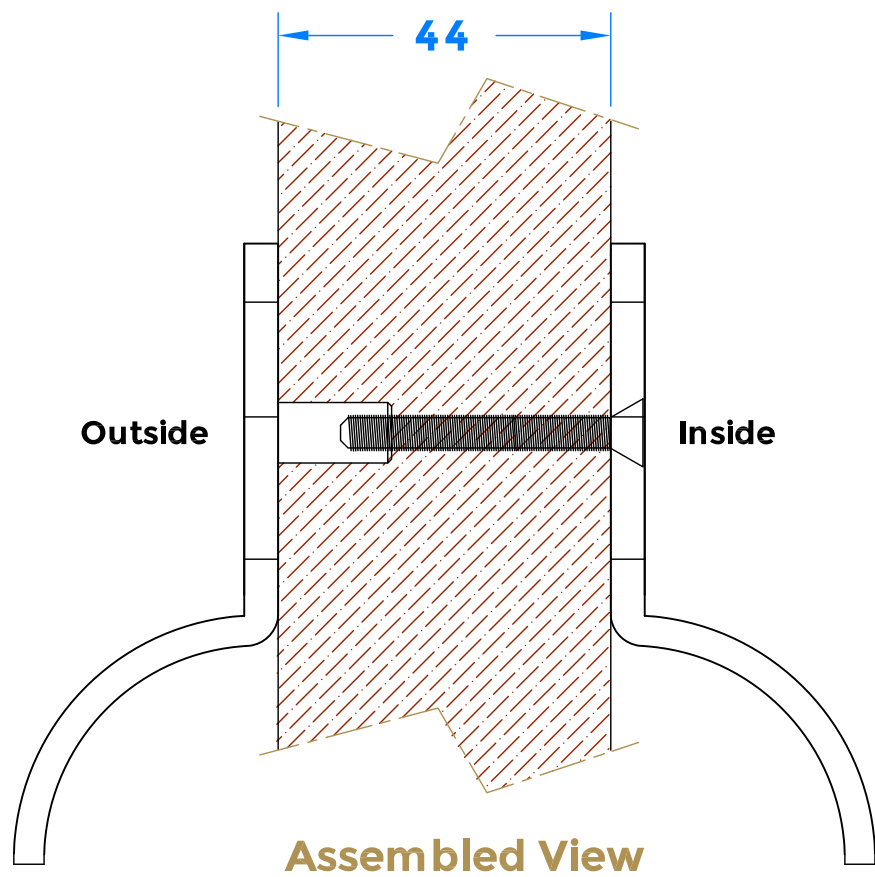
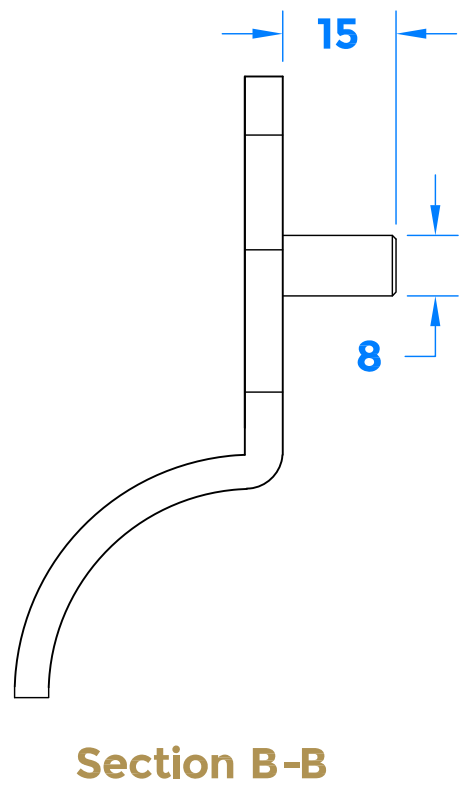
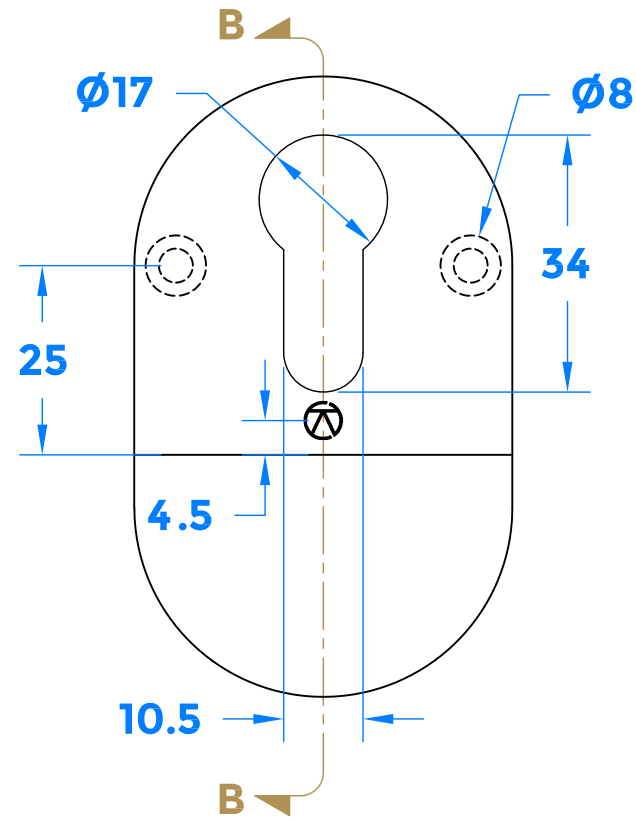
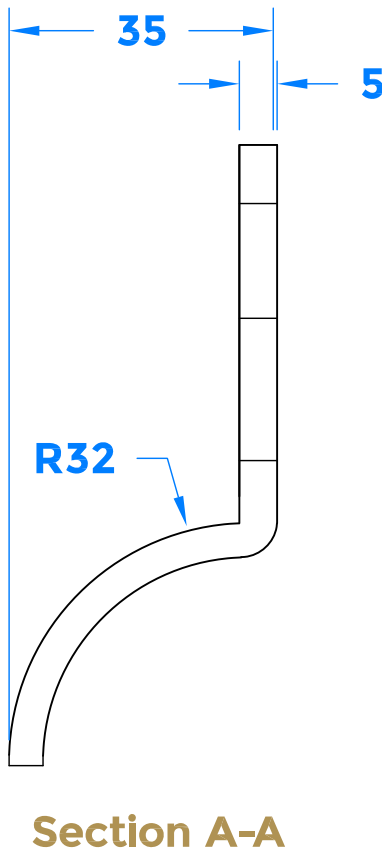
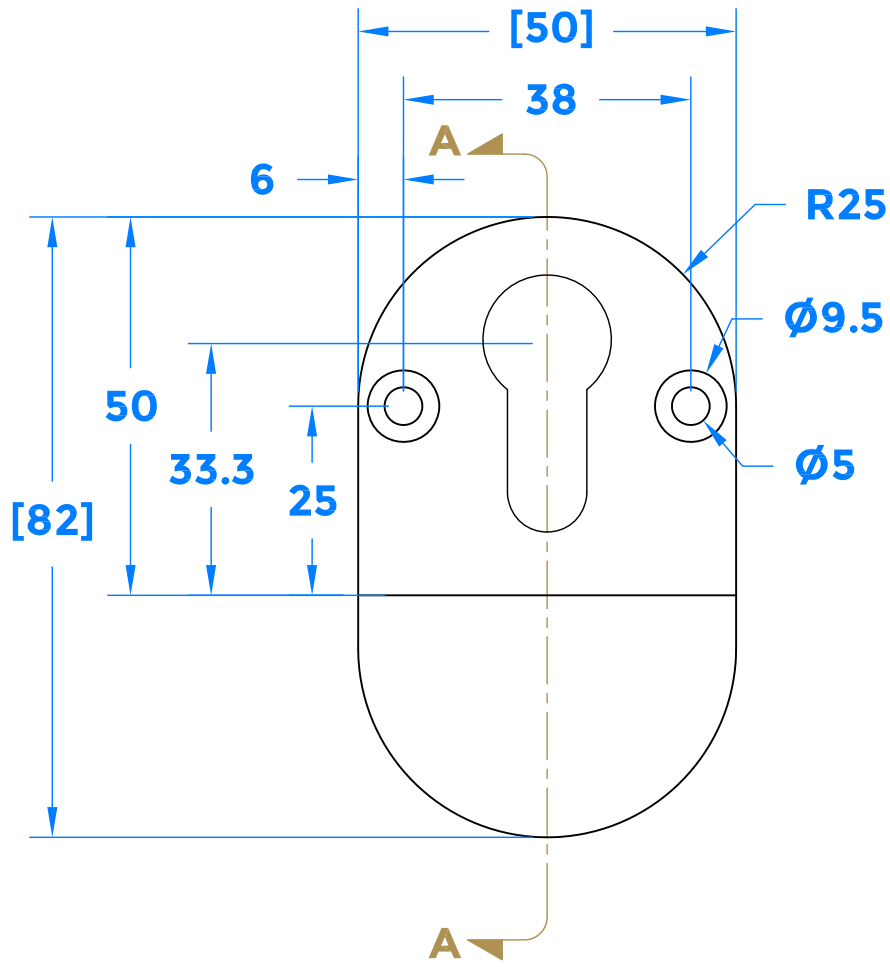

coastal-group.com
Shaping the future.

Part Number /Drawing Title: CP53 Back to Back Cylinder Pull Set	
Product Range: Door Furniture	
Material:	316 Stainless Steel
Additional Info:	Door Thickness of 44mm
Date Drawn:	03/04/2023
Drawn By:	Philip Walklett
Part Number:	CP53
File Name:	CP53.dwg
Revision:	B
Drawing Scale:	1:1@ A3
Sheet Number:	1 of 1
THIRD ANGLE PROJECTION	
This drawing and specification are the property of Coastal Specialist Ironmongery Ltd, they are issued in strict confidence and shall not be reproduced, copied or used without written permission. EAOE -All dimensions are specified in mm.	