

Drawing Revision History		
Revision	Description / Change	Date
A	Release	15/11/2021

Claw Type Sash Fastner

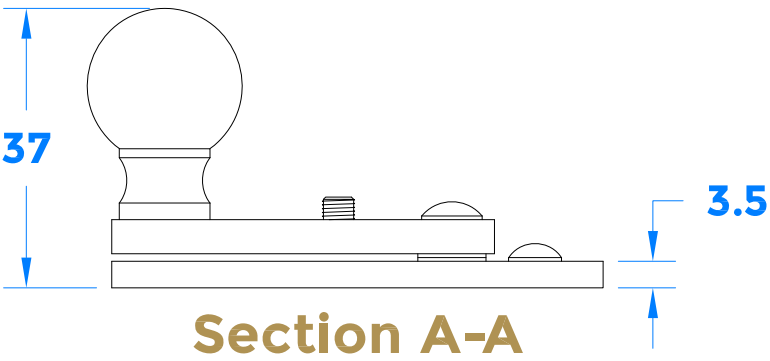

Claw Type Sash Fastner Keep

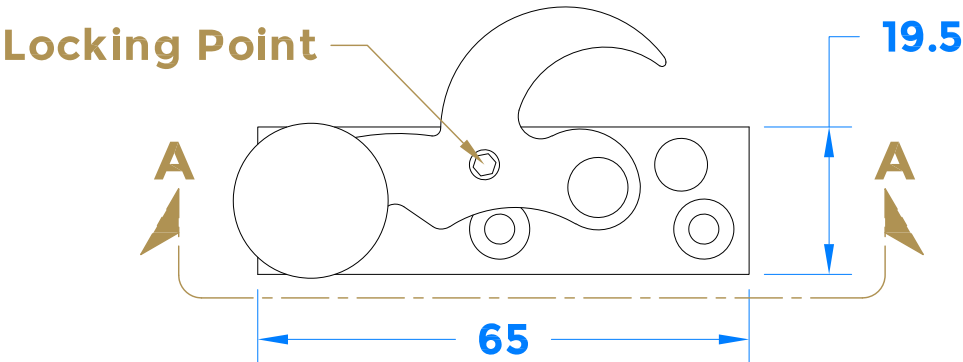
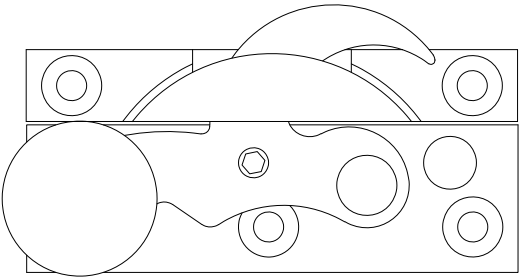
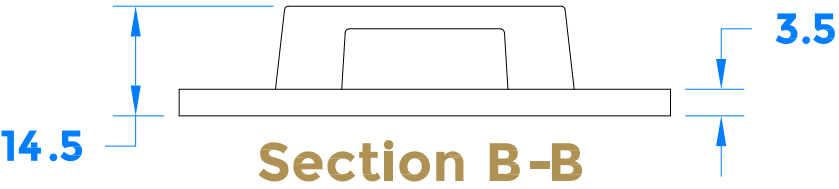
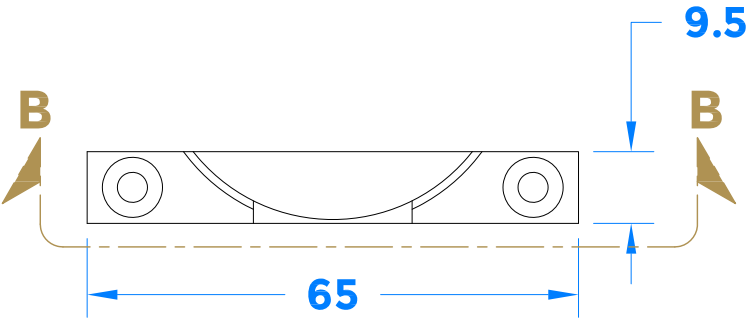

Locked Position

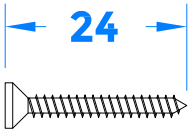



coastal-group.com
Shaping the future.

Part Number / Drawing Title:
GL40
Standard Claw Fastener

Product Range:
Sliding Sash Hardware

Material: Brass

Additional Info:

Date Drawn: 15/11/2021

Drawn By: Philip Walklett

Part Number: GL40

File Name: GL40.dwg

Revision: A

Drawing Scale: 1:1@ A3

Sheet Number: 1 of 1

THIRD ANGLE PROJECTION



This drawing and specification are the property of Coastal Specialist Ironmongery Ltd, they are issued in strict confidence and shall not be reproduced, copied or used without written permission.
E&OE - All dimensions are specified in mm.