

SURFACE SLIDE DOOR BOLTS

Product Code: AQ8

LIT-DC-AQ8



Door Hardware Range

- Quality surface mounted door bolt
- Low profile bolt
- Smooth easy sliding action to trigger the bolt
- Flat barrel provides increased security over conventional barrel bolt
- Can be fixed either horizontally or vertically
- Often used to secure the top and bottom leaves on stable doors



COASTAL

Shaping the future.

Front Profile Closed Position

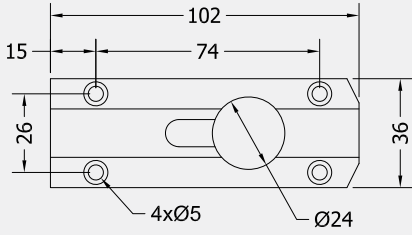

Front Profile Open Position

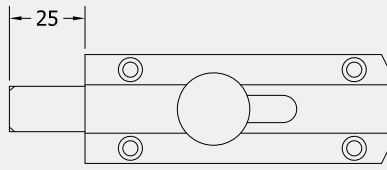

Angled Keep

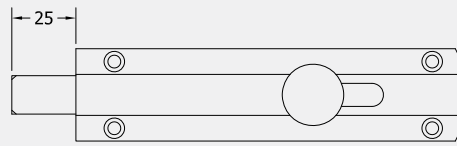
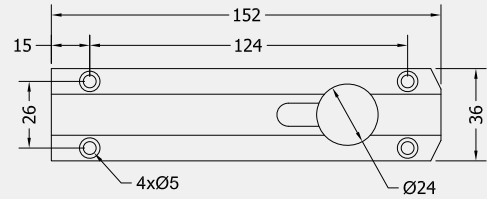
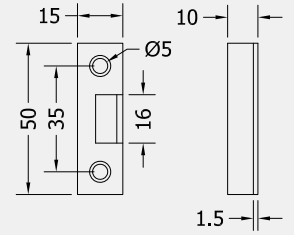

Box Keep

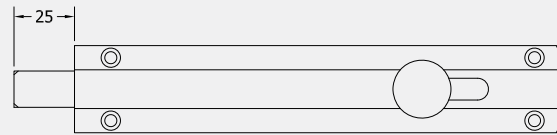
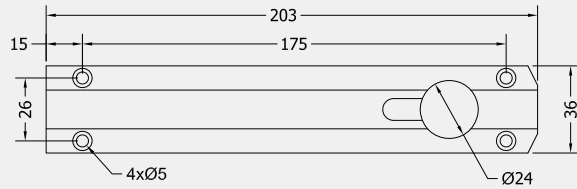
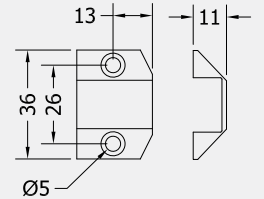

Flat Plate Keep

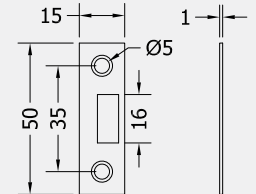

Visit www.coastal-group.com for CAD drawings

FINISHES:



SC
Satin Chrome



CP
Polished Chrome



PBP
Polished Brass

PART NUMBER	PRODUCT DESCRIPTION	FINISH	UNITS
AQ81-SC	102 x 36mm Surface bolt	SC	Each
AQ81-CP	102 x 36mm Surface bolt	CP	Each
AQ81-BP	102 x 36mm Surface bolt	PBP	Each
AQ82-SC	152 x 36mm Surface bolt	SC	Each
AQ82-CP	152 x 36mm Surface bolt	CP	Each
AQ82-BP	152 x 36mm Surface bolt	PBP	Each
AQ83-SC	203 x 36mm Surface bolt	SC	Each
AQ83-CP	203 x 36mm Surface bolt	CP	Each
AQ83-BP	203 x 36mm Surface bolt	PBP	Each

