

## *Tall Multipoint Lock for Single Doors*

ML50S Tall Single Door Hookbolt Lock

T 01726 871 025 E [sales@coastal-group.com](mailto:sales@coastal-group.com) W [coastal-group.com](http://coastal-group.com)  
© Coastal Specialist Ironmongery Ltd



# COASTAL

*Shaping the future.*

## TALL SINGLE DOOR MULTIPOINT LOCK - HOOKBOLT

### TECHNICAL INFORMATION:

- 92mm Euro Lock Centre
- 45 or 55mm Backset options
- Universal Lock Handing  
(Latch Release)



### FEATURES:

- Ideal Winkhaus multipoint door lock with additional locking points for tall doors
- Anti 'push-back' hook bolts provide excellent security
- Enhanced high performance gearbox design with latest security and easy to operate locking
- Tested to PAS24 and Secured by Design Approved

### Keep Handing (as viewed from outside)

Left Hand Lock

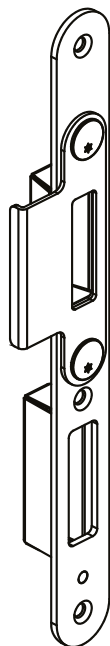

Right Hand Lock

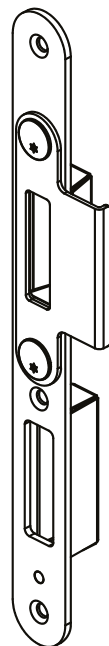

## TALL SINGLE DOOR MULTIPOINT LOCK - HOOKBOLT

## KIT CODES

KIT PART NUMBER	HANDING	BACKSET	FACEPLATE	CENTRE	FINISH	UNITS
ML50S-KIT-45-33-LH	Left	45mm	20mm Square	33mm	SV	Each
ML50S-KIT-45-33-RH	Right	45mm	20mm Square	33mm	SV	Each

Kit includes 1 x ML50S multipoint lock, 1 x MK9 Centre keep and 3 x MK7-FLU keeps

## COMPONENT CODES

LOCK PART NUMBER	HANDING	BACKSET	FACEPLATE	FINISH	UNITS
ML50S-45-3-SV	Universal	45mm	20mm Square End	SV	Each
ML50S-55-3-SV	Universal	55mm	20mm Square End	SV	Each

## KEEP CODES

KEEP PART NUMBER	PRODUCT DESCRIPTION	HANDING	CENTRE	FINISH	UNITS
MK7-FLU-SV	Single keep	Universal		SV	Each
MK9-28-LH-SV	Centre keep	Left	28mm	SV	Each
MK9-28-RH-SV	Centre keep	Right	28mm	SV	Each
MK9-33-LH-SV	Centre keep	Left	33mm	SV	Each
MK9-33-RH-SV	Centre keep	Right	33mm	SV	Each
MK7-FTB-AAL	Flush single keep	Universal	Adjustable	SV	Each
MK9-FTB-22-AAL	Non-handed premium flush centre keep, 22mm centre	Universal	Adjustable	SV	Each
MK9-FTB-28-AAL	Non-handed premium flush centre keep, 28mm centre	Universal	Adjustable	SV	Each

## FINISHES:



SV

Silver Passivated



TALL SINGLE DOOR MULTIPOINT LOCK - HOOKBOLT

What are faceplate widths?

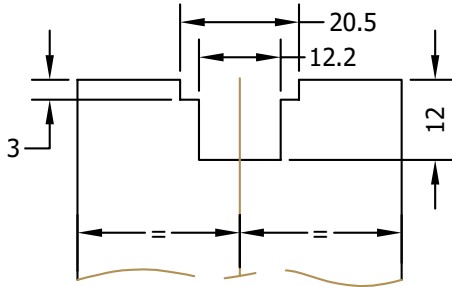

SECTION A-A  
EURO GROOVE

- Typical faceplate width is 20mm, this is measured across the face of the lock
- The diagram above shows typical routing detail

How to release the latch on a non-handled (universal) multipoint lock

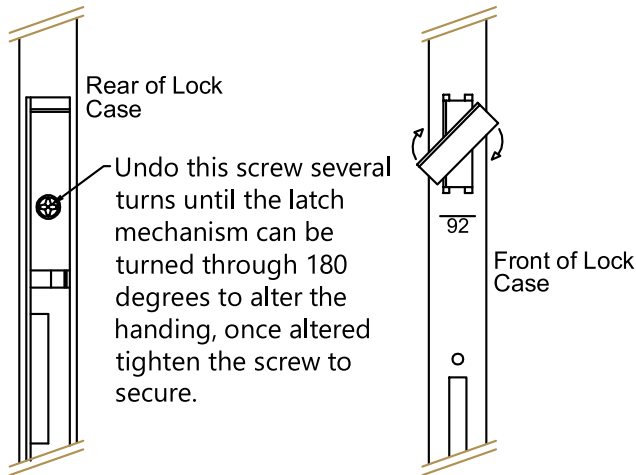

Detail A  
Latch Release

TALL SINGLE DOOR MULTIPOINT LOCK - HOOKBOLT

MK7-FTB

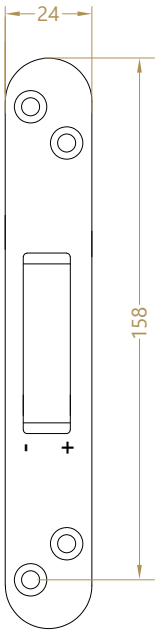

MK7-FLU

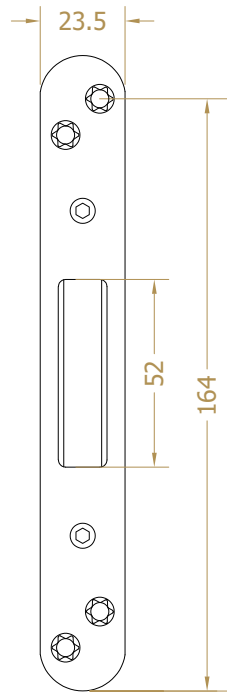

MK9-28

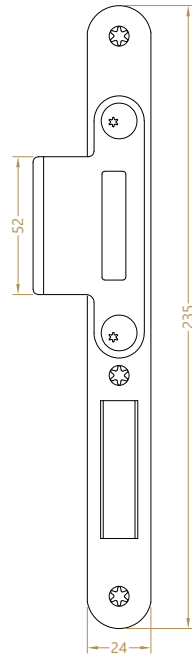

MK9-FTB-28

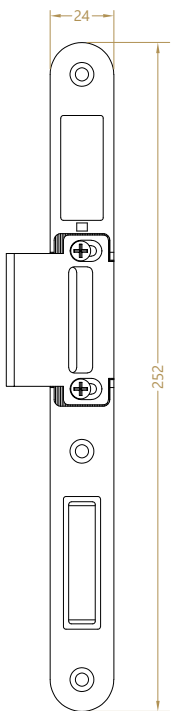

MK9-33-SV

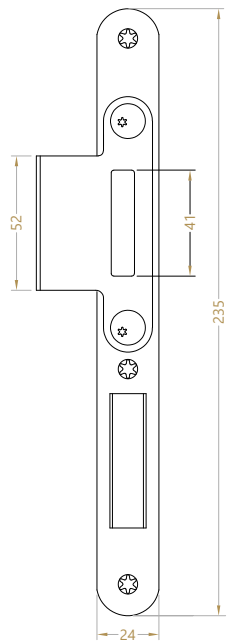

MK9-FTB-22

